



THE FORMWORK

# NOE<sup>®</sup> top S

Dated: 07.2021

Assembly and  
Operating Manual

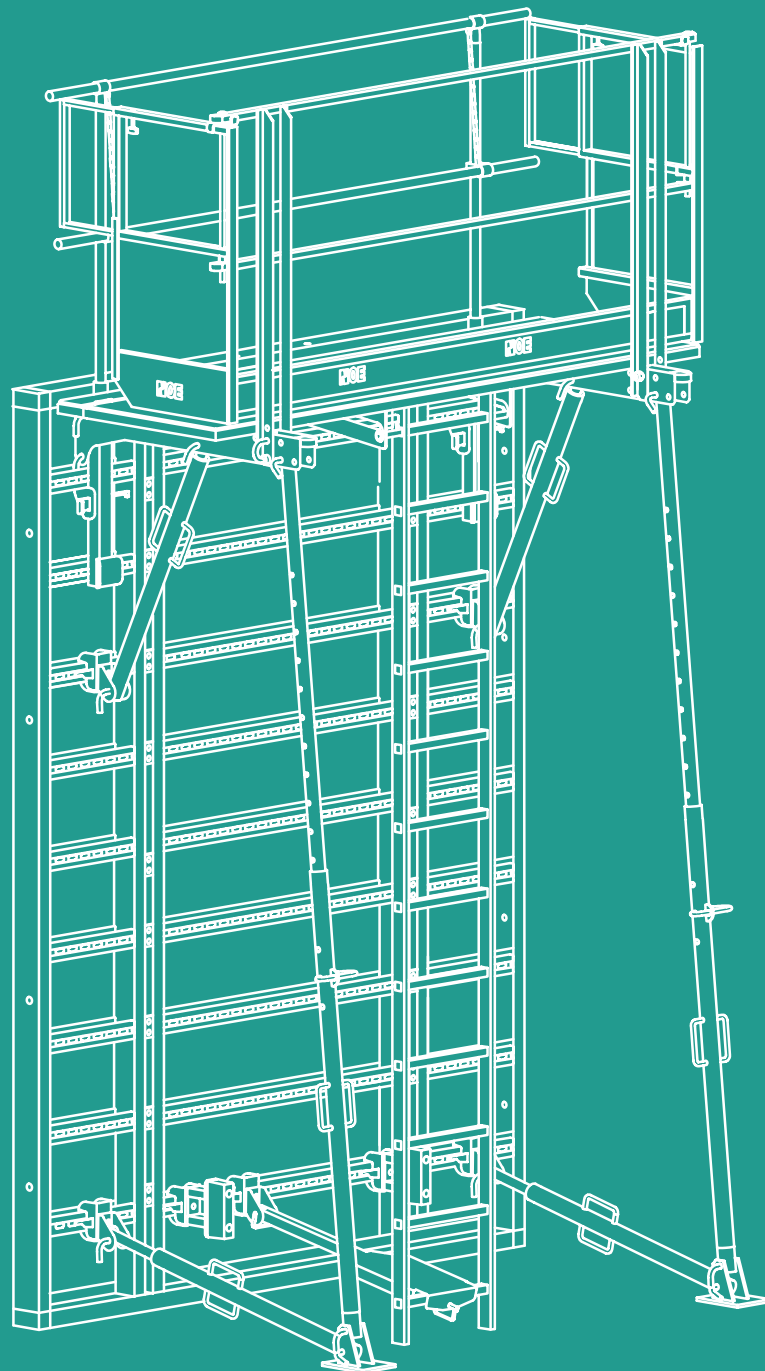



## Contents

	<i>Page</i>
1	4
1.1	4
2	5
3	6
3.1	6
3.2	7
3.3	7
4	8
4.1	8
4.1.1	8
4.2	13
4.3	16
4.3.1	16
4.3.2	17
4.3.3	18
4.3.4	18
5	20
5.1	20
5.1.1	20
5.1.2	20
5.1.3	21
5.1.4	21
5.2	22
5.3	23
5.3.1	23
5.3.2	24
5.3.3	25
5.4	25
5.4.1	25
5.4.2	26
5.5	27
6	28
7	30
8	30
9	31

## 1 Safety advice, GSV guidelines

### 1.1 Advice on proper and safe use of formwork and falsework

The contractor is responsible for drawing up a comprehensive risk assessment and a set of installation instructions. The latter is not usually identical to the assembly and use instructions.

- **Risk assessment:** The contractor is responsible for the compilation, documentation, implementation and revision of a risk assessment for each construction site. His employees are obliged to implement the measures resulting from this in accordance with all legal requirements.
- **Installation instructions:** The contractor is responsible for compiling a written set of installation instructions. The assembly instructions form part of the basis for the compilation of a set of installation instructions.
- **Assembly and use instructions:** Formwork is technical work equipment and is intended for commercial use only. It must be used properly and exclusively through trained specialist personnel and appropriately qualified supervising personnel. The assembly and use instructions are an integral component of the formwork construction. They comprise at least safety guidelines, details on the standard configuration and proper use, as well as the system description. The functional instructions (standard configuration) contained in the assembly instructions are to be complied with exactly as stated. Enhancements, deviations or changes represent a potential risk and therefore require separate verification (with the help of a risk assessment) or a set of installation instructions that comply with the relevant laws, standards and safety regulations. The same applies in those cases where formwork and/or falsework components are provided by others on site.
- **Availability of the assembly and use instructions:** The contractor must ensure that the assembly and use instructions provided by the manufacturer or formwork supplier are available at the place of use, that site personnel are informed of this before assembly and use takes place, and that they are available at all times.
- **Representations:** The representations (drawings, diagrams etc.) shown in the assembly instructions are, in part, situations of assembly and not always complete in terms of safety considerations. Any safety installations that may not have been shown in these representations must nevertheless be available.
- **Storage and transportation:** Any special requirements relating to transportation procedures and storage of the formwork constructions must be complied with. An example would be the use of the appropriate lifting gear.
- **Material check:** Formwork and falsework material deliveries are to be checked on arrival at the construction site/place of destination as well as before each use to ensure that they are in perfect condition and function correctly. Changes to the formwork materials are not permitted.
- **Spare parts and repairs:** Only original components may be used as spare parts. Repairs are to be carried out by the manufacturer or at authorised repair facilities only.
- **Use of other products:** Combining formwork components from different manufacturers carries certain risks. They are to be individually verified and can result in the compilation of a separate set of assembly instructions required for the installation of the equipment.
- **Use of other products:** Individual safety symbols are to be complied with. Examples:



**Safety information:** Non-compliance can lead to damage to materials or risk to the health of site personnel (also life).



**Visual check:** The intended operation is to be subject to a visual check.



**Note:** Supplementary information for safe, correct and professional execution of work activities.

- **Miscellaneous:** We reserve the right to make amendments in the course of technical development. All current country-specific laws, standards and other safety regulations are to be complied with without exception for the safe application and use of the products. They form a part of the obligations of employers and employees regarding industrial safety. This gives rise to, among other things, the responsibility of the contractor to ensure the stability of the formwork and falsework constructions as well as the structure during all stages of construction, which also includes the basic assembly, dismantling and the transport of the formwork and falsework constructions or their components. The complete construction is to be checked during and after assembly.

## 2 Safe setting down of wall formwork elements

*Double-faced formwork system*

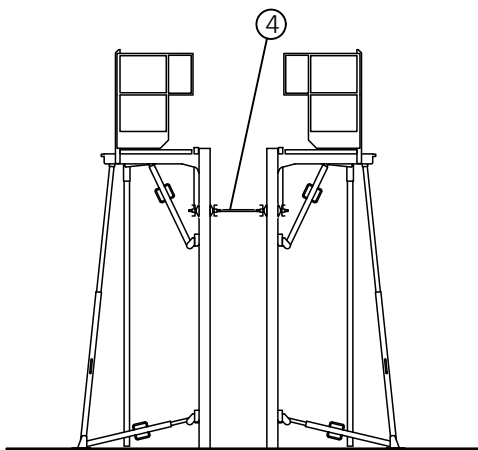
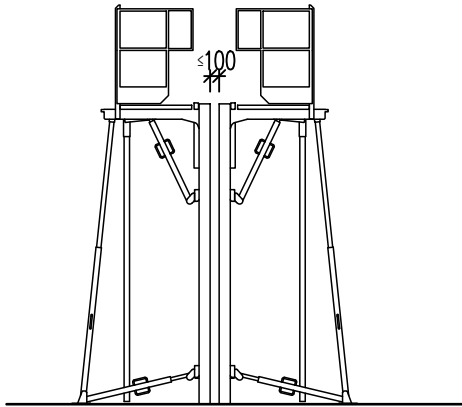

*Single-faced formwork system*

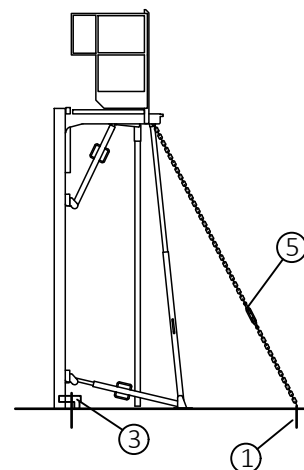
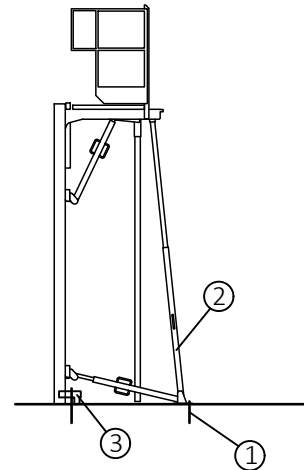

To avoid accidents always set elements down in such a way that they are structurally stable (guy, brace, anchor); this includes placing them down safely on the ground.

If the stabilizers are anchored in the ground, they must be able to act in compression and tension. At least 2 stabilizers must be attached to single panels. Attach the uplift safety device in the event of wind loads.

For attaching stabilizers, see → 5.4.2

- 1 Anchor bolt
- 2 Stabilizer anchored
- 3 Uplift safety device
- 4 Tie rod  
(to resist tension and compression)
- 5 Guy

### 3 Overview of the NOEtop S

#### 3.1 Overview of complete element

NOEtop S combines formwork, scaffold platform, guard rails, ladder and stabilizers in a single formwork and safety element. The safety components of the formwork element are folded before being moved and folded out again at the next location. There is no need to dismantle individual parts.

The system widths embrace large panels as well as medium and small sizes, thereby offering flexible formwork together with safety.

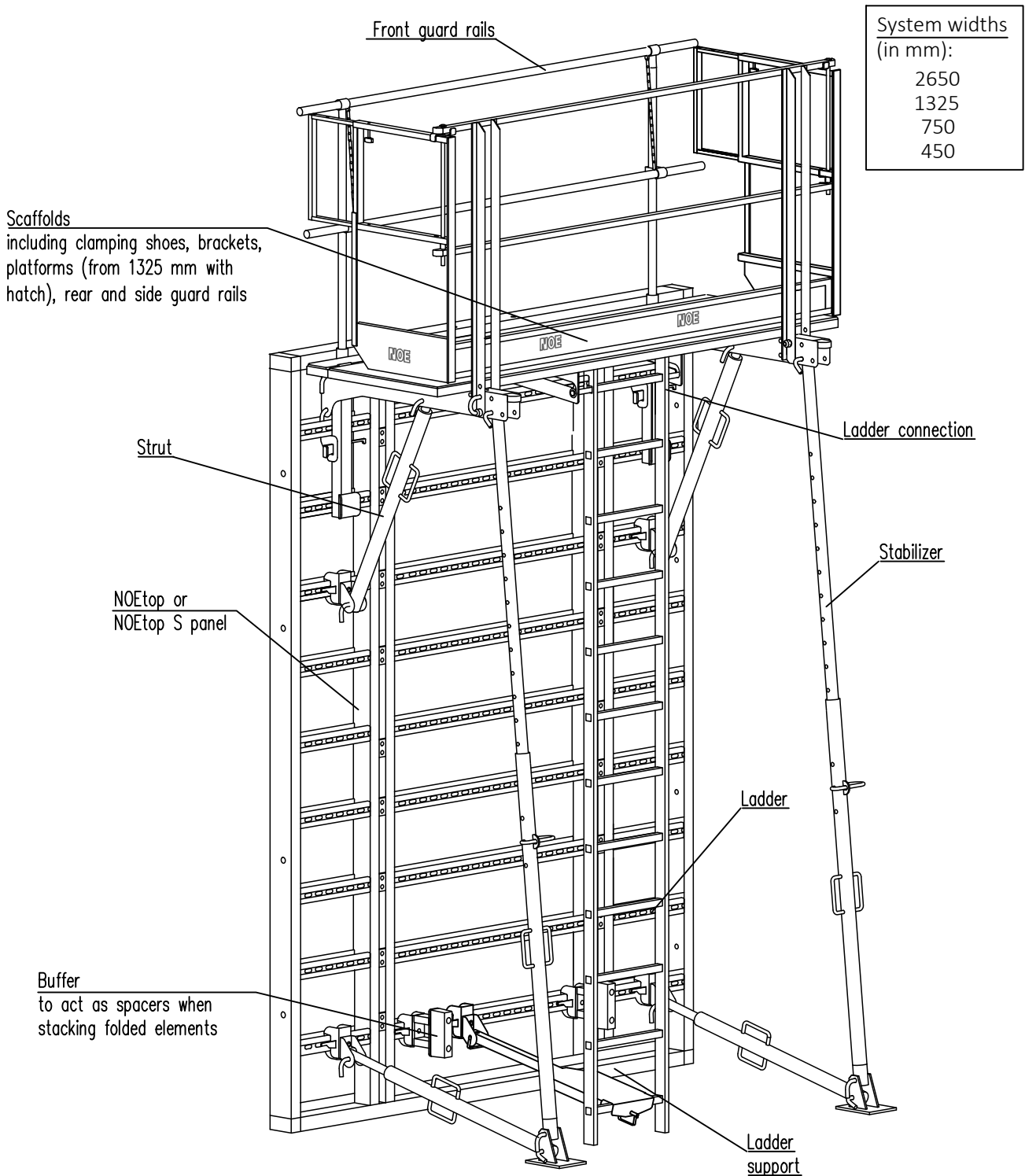

3.2 Description of scaffold parts

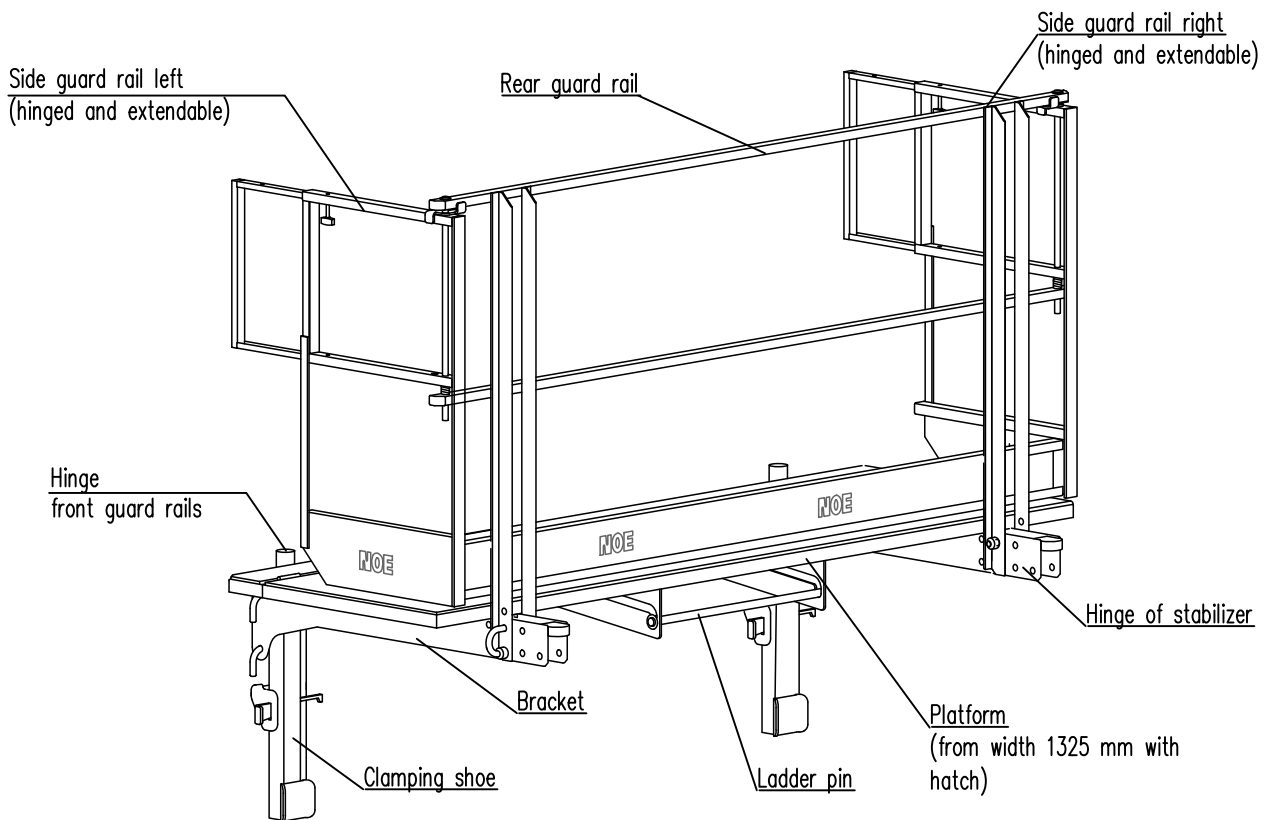

3.3 System dimension of scaffold

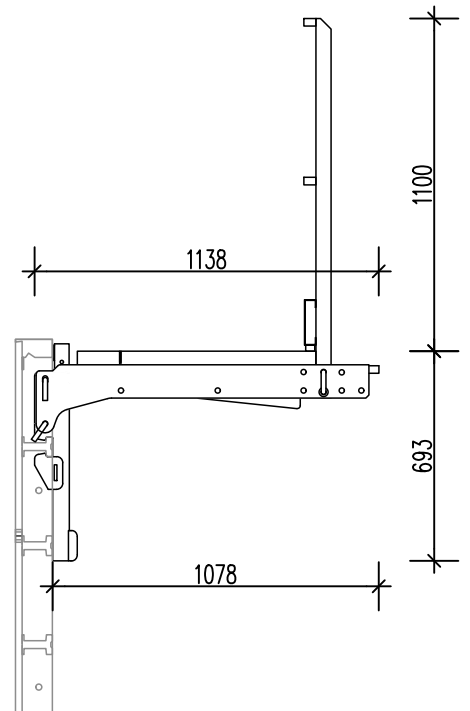
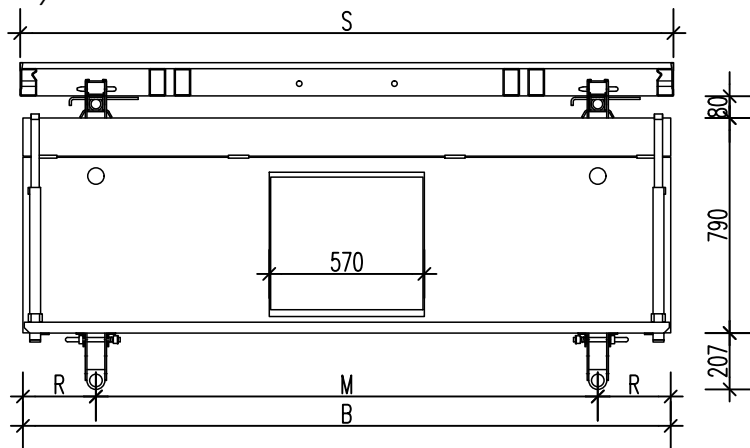

System width S [mm]	Element width B [mm]	Bracket spacing [mm]	
		R	M
2650	2630	340	1950
1325	1305	250	805
750	730	190	350
450	430	215	--

## 4 Assembly and use of NOEtop S elements



Before using the formwork, read through the assembly and use manual and observe the safety advice given in each chapter at all times!  
Everyone who works with the product must receive instruction from a suitably qualified member of the site supervisory staff.



A hazard analysis must be performed for all situations on the site by a qualified person.  
Components must be free of defects. Therefore visual inspection and/or testing of each component are essential at all stages of the work!

The individual steps for the initial assembly of the standard elements is described below. The description refers to elements with a width of 0.75 m to 2.65 m. The individual steps can be found in full detail in the relevant sections. They also draw attention to the differences in the assembly of the smaller elements.

- Refer to the detailed and exhaustive diagrams of the steps in the relevant sections.  
For extended formwork please also take note of the NOEtop Assembly and Operating Manual (AuV).

Es Initial assembly and erection of formwork will now be illustrated, together with a description of how to move complete units.

### 4.1 Initial assembly of an NOEtop S unit

#### 4.1.1 Assembly of formwork with scaffold, ladder and stabilizers

- ◆ Place NOEtop or NOEtop S panels on a level surface and prepared substructure.

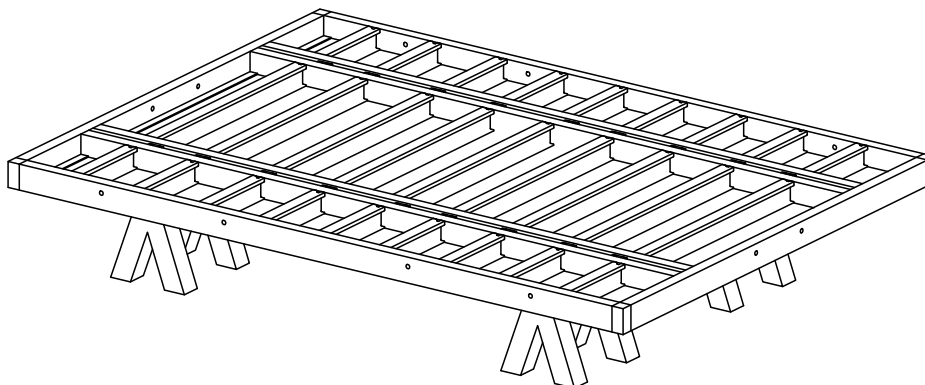



# Assembly and Operating Manual

## NOEtop S



### ◆ Fold out NOEtop S platform

- Swing out rear guard rail; see → 5.1.1

Delivery state

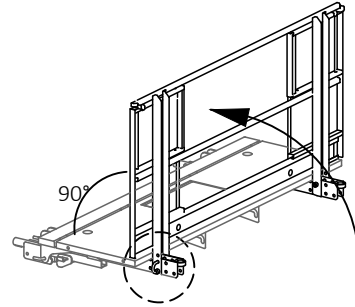
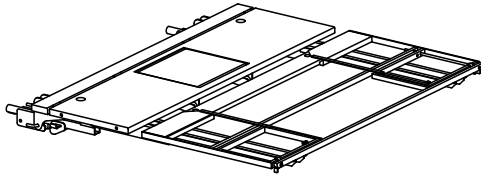

Open pin, fold out rear guard rail, and close pin!

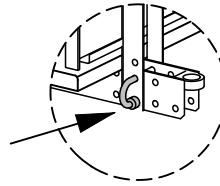

- Folding up the platform (90° to clamping shoe); see → 5.1.2  
Do this while propping or carefully tipping element.

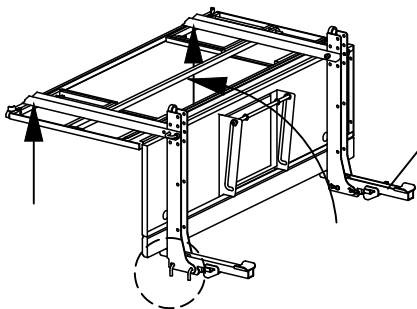

Clamping shoe

Remove pin, fold up platform, insert pin and secure!

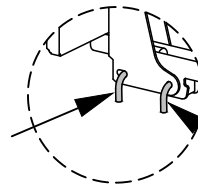

Pin remains in place.



After folding out, check that platform and guard rail sit correctly!

- ◆ Suspend platform from the crane eyes and slew to the formwork. Suspend the platform with the lugs of the two suspension devices in the uppermost top-hat profile section and secure by driving in the wedge. Then once that is done detach the crane rope; see → 5.1.3

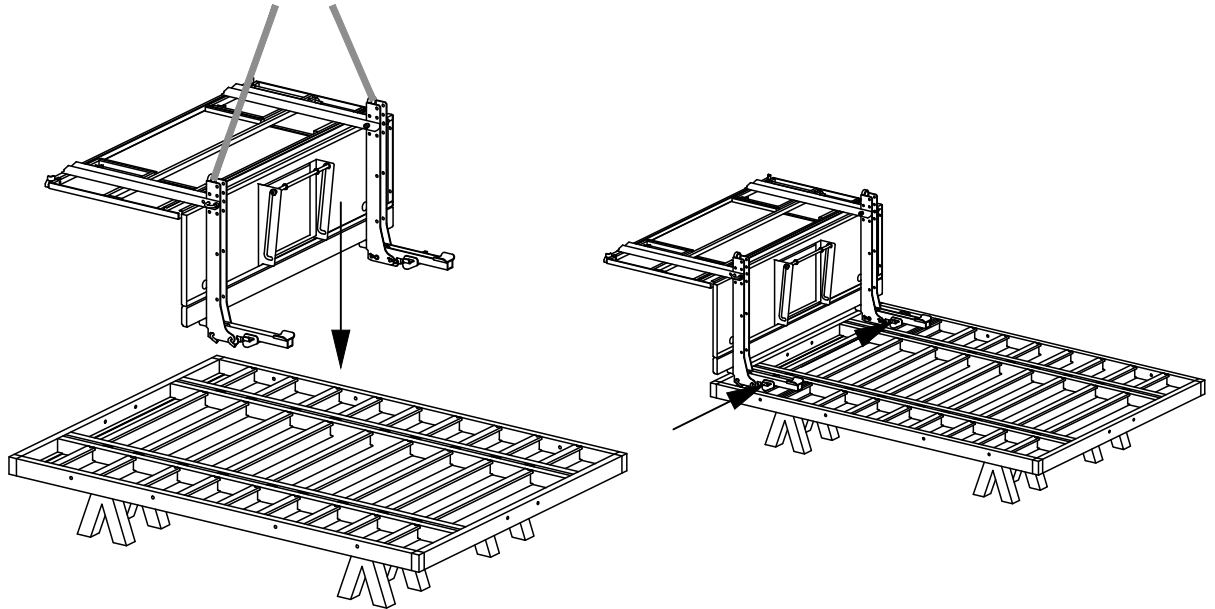

- ◆ Use the clamping jaw to mount 2 buffer supports in the bottom top-hat profile, and secure by driving in the wedge, see → 5.2

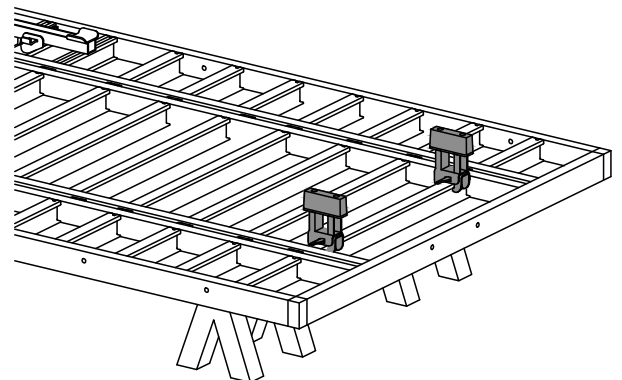

- ◆ NOE LSS ladders can be attached to elements having a hatch directly by the pivot in the platform.

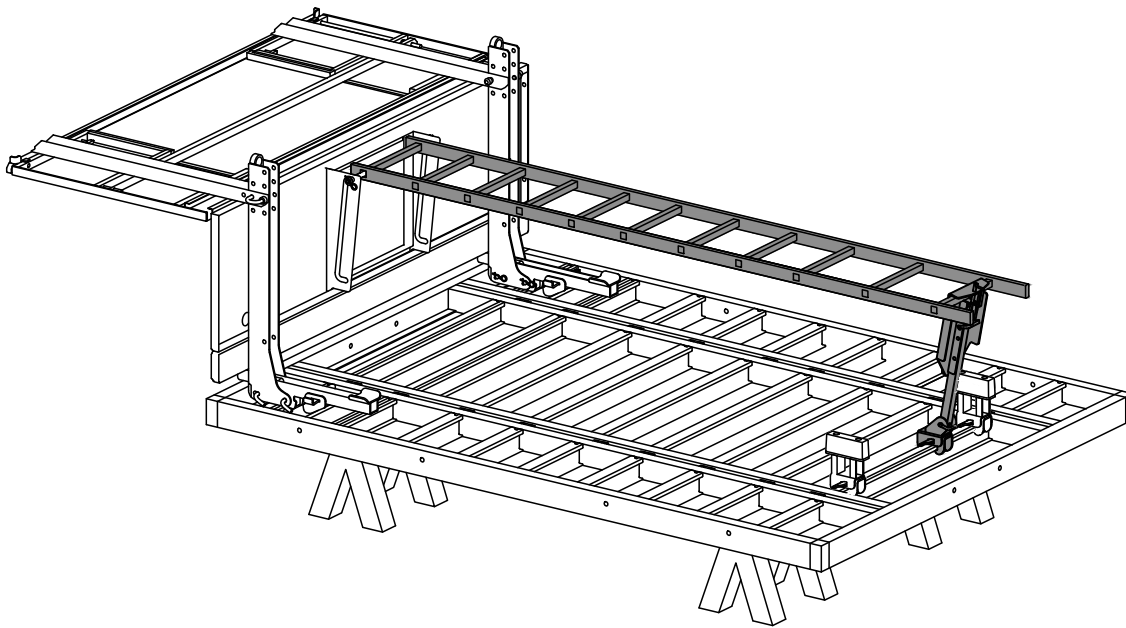

- ◆ Fit bracing struts to platform and frame formwork;  
see → 5.4.1

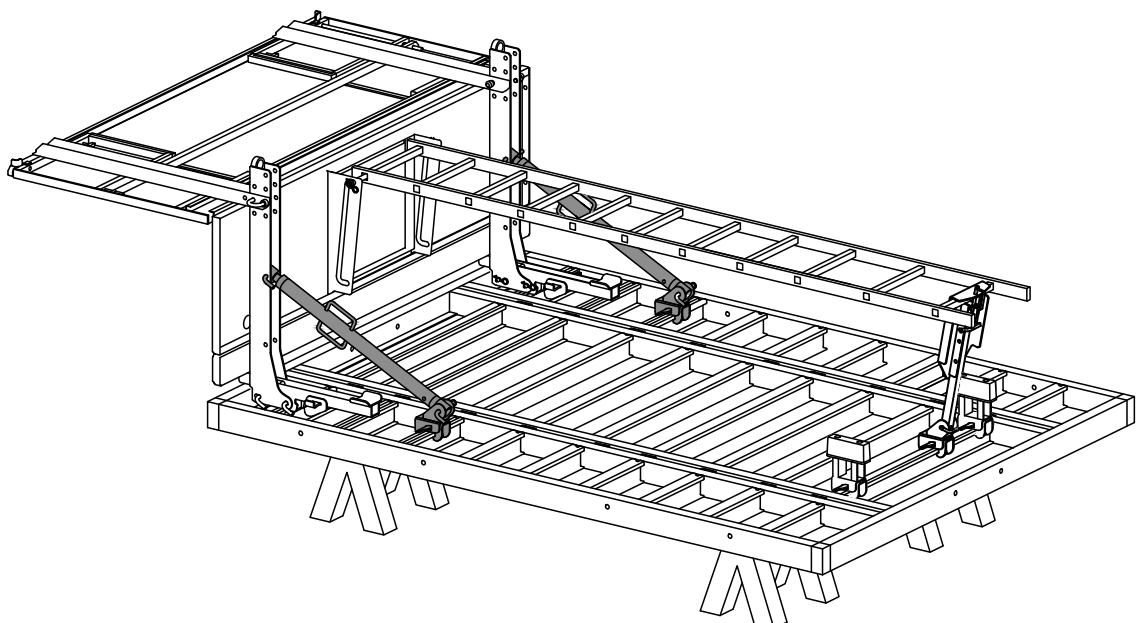

- ◆ Fit stabilizers; see → 5.4.2

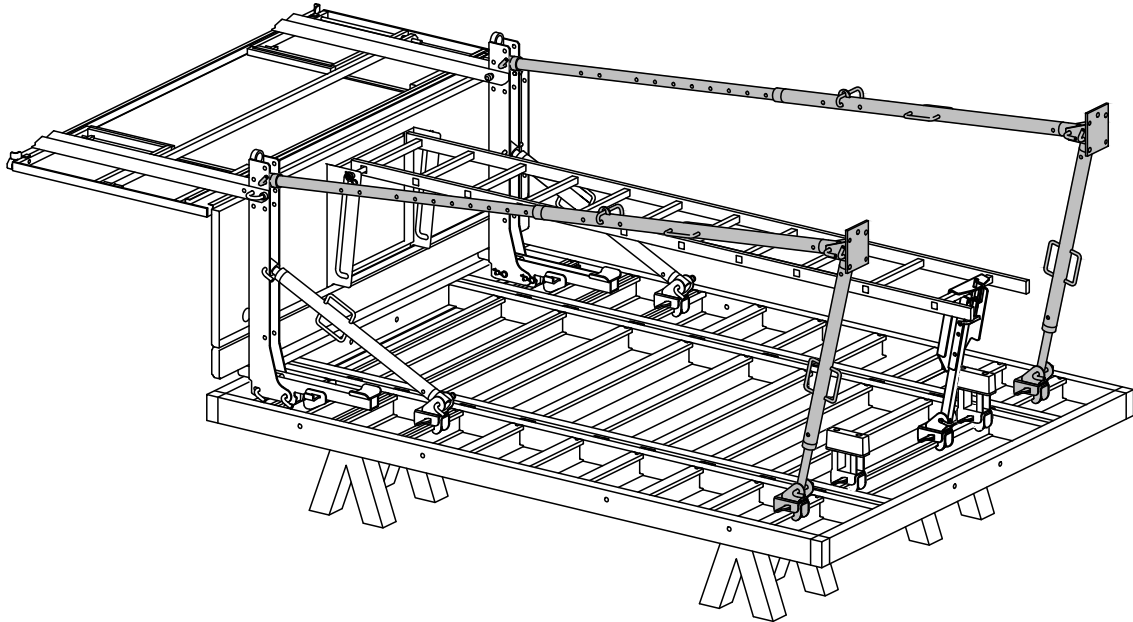

- ◆ Fit front guard rails on the formwork side of the scaffold platform to safeguard against falling

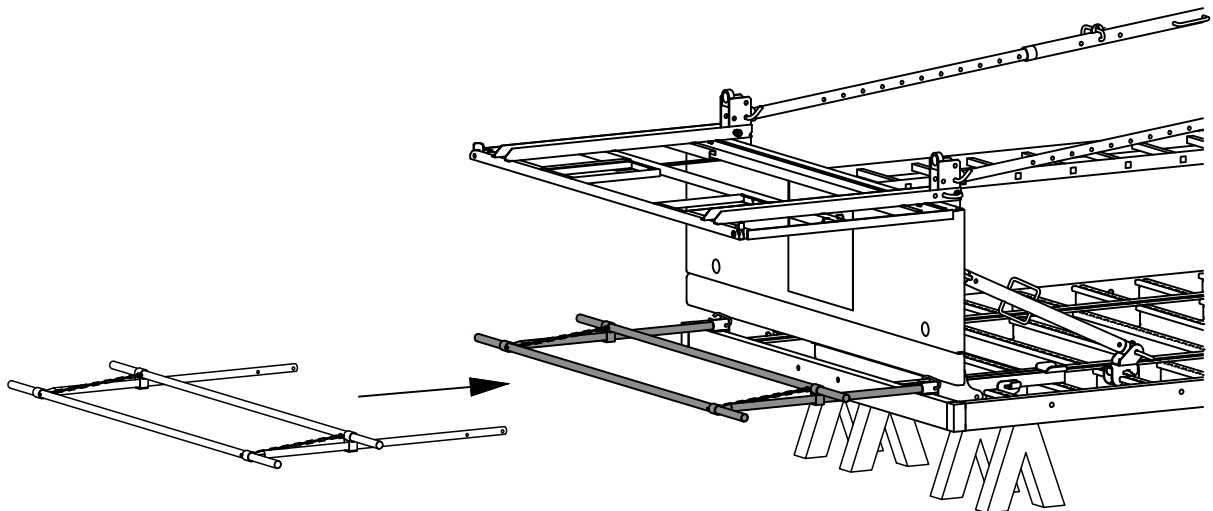

For the sake of clarity the following illustrations are simplified and the front guard rail is not shown!

- ◆ Swing out both side guard rails (on platforms 1.325-2.65 m).  
These safeguard against falling when erecting the elements;  
See → 5.1.4

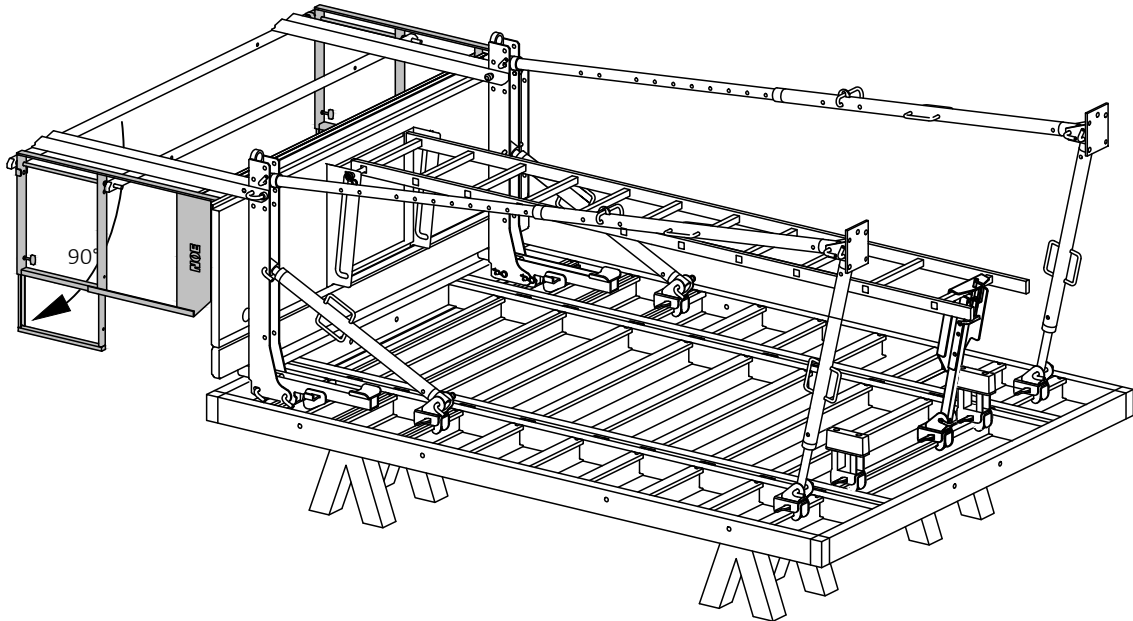

#### 4.2 Erecting NOEtop S units

- ◆ Open platform flap and engage crane hook in the edge profile of the frame formwork.
- ◆ Fit lifting dog for erecting the formwork and attach crane rope to lifting dog.  
Lift slowly with the crane and move to the point of use.



For the mounting and use of the crane clamp and lifting dog observe the requirements and advice listed in the separate operating instructions.

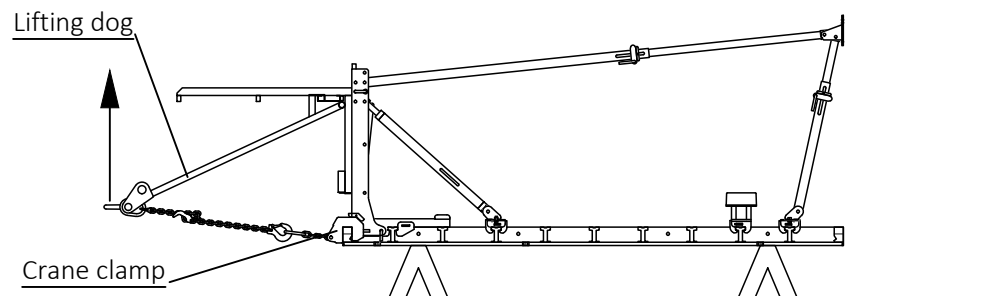

- ◆ Set down and align the element at the point of use, and attach stabilizers to resist tension and compression. Only then unhook from the crane.

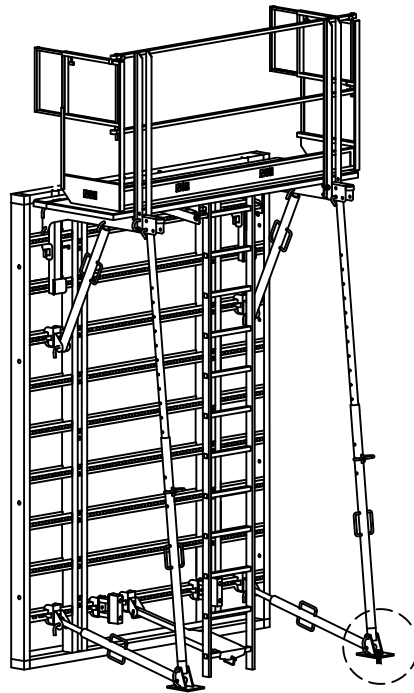

For the sake of clarity, front guard rails to safeguard against falling are not shown in the assembly diagrams.

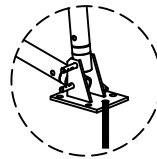

- ◆ Prepare second element as before, but without ladder, move with the crane and set down.

Attach element connection, anchor stabilizers to resist tension and compression, and only then detach from the crane.

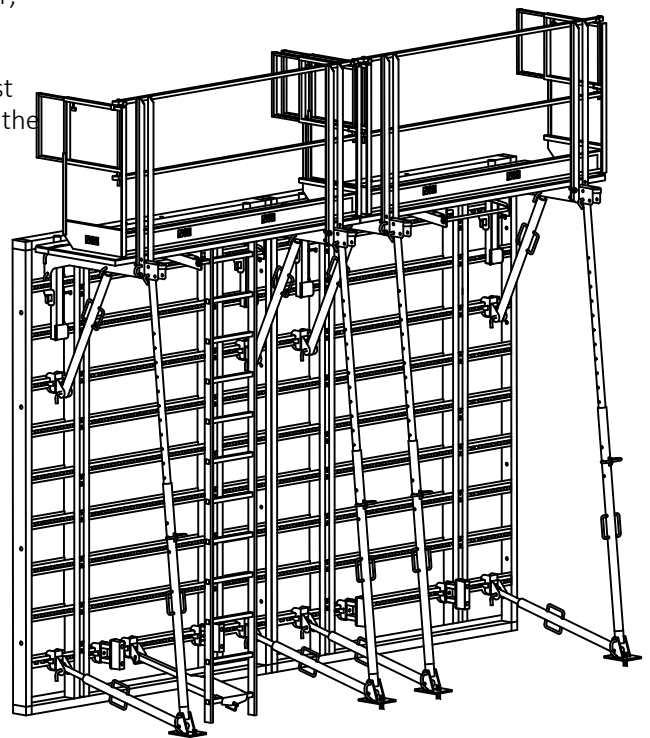

- ◆ Side guard rails at butt joint of both elements can now be folded in.

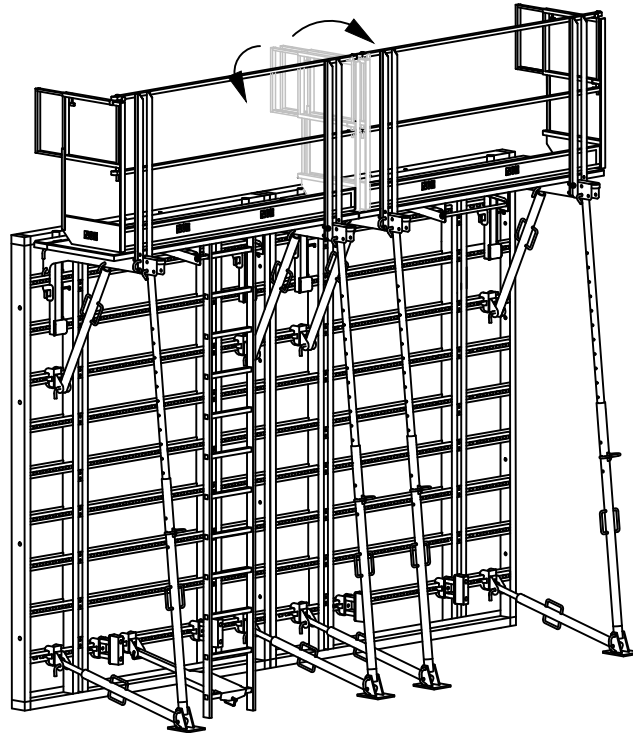

Erect the complete formwork in accordance with the illustration.



On each occasion before use, the scaffold is to be inspected for correct and safe erection.

Subsequent steps, such as applying release agent, erecting the second face formwork, important things for concreting and stripping etc. can be found in NOEtop.



For all the necessary steps before, during and after concreting, NOEtop Assembly and Operating Manual (AuV) must be observed.

### 4.3 Folding and moving preassembled units

After the initial assembly it is not necessary to dismantle the units before moving to the location, but simply fold them.

#### 4.3.1 Preparation of folding process

Prior to folding the formwork must be safely set down with the front side sitting level on squared timber or similar. Then carry out steps 1-5.

Raking props:

1. Release stabilizer connections of push-pull braces and struts from the formwork.
2. Remove short strut from the bracket.
3. Withdraw safety pin of long stabilizer strut.

Ladder:

4. Remove ladder support completely.
5. Push ladder to the back of the formwork  
(Press ladder towards top edge, move it with the ladder pivot in the groove, and pull down towards bottom edge until it engages in the recess again).

Scaffold:

6. Fold in both side guard rails.

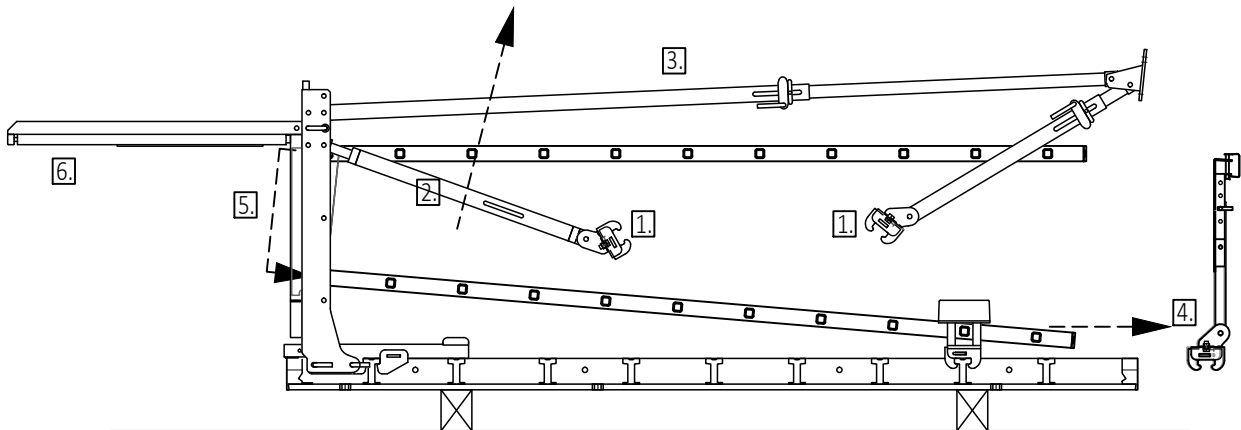



### 4.3.2 Folding the units

Once the attachments have been released as described, the element can be folded in 3 steps:

7. Pull out the pins on both sides, fold back bracket onto the formwork, and then reinsert both pins.
8. Open pins on both sides, fold guard rails and reclose pins.
9. If front guard rails fitted, release pins on both sides and push in as far as they will go.

In addition, two further assembly steps may be necessary (for clarity illustrated in two different views):

10. Lay struts on the formwork and retract them as far as possible so that they do not project, or only by a small amount.

◆ showing stabilizers and front guard rail

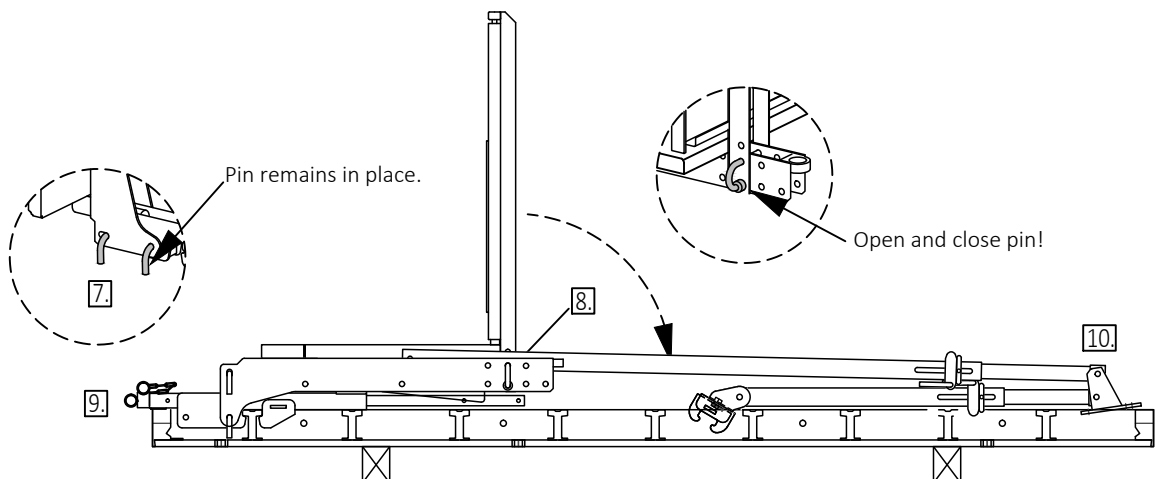

◆ showing ladder

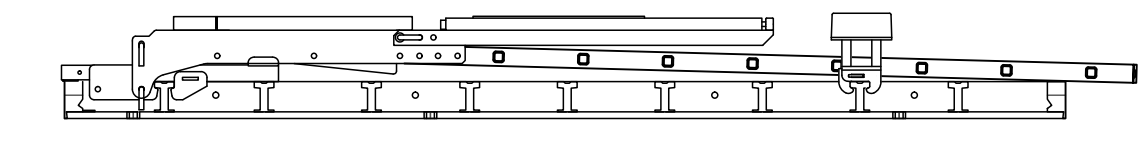
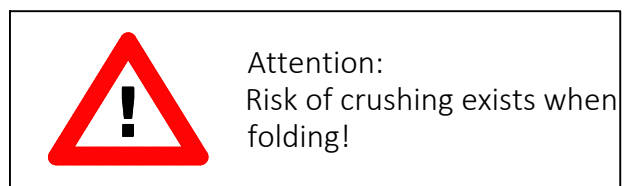

### 4.3.3 Stacking units prior to transport

The folded elements can be stacked on top of one another without any special measures. They rest on attached buffer supports and on buffers integrated in the scaffold.

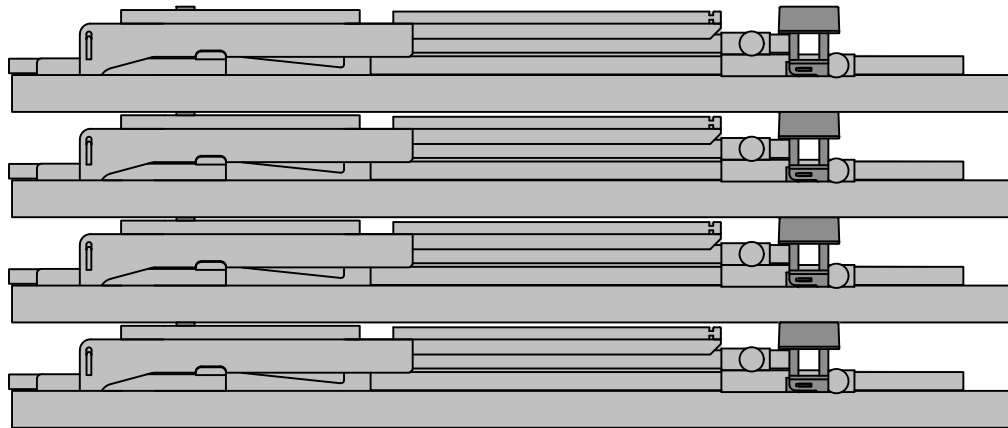

### 4.3.4 Folding out the formwork

As this is done in the reverse order from folding, which was illustrated in detail in the last section, only a few steps of the procedure will be shown here.

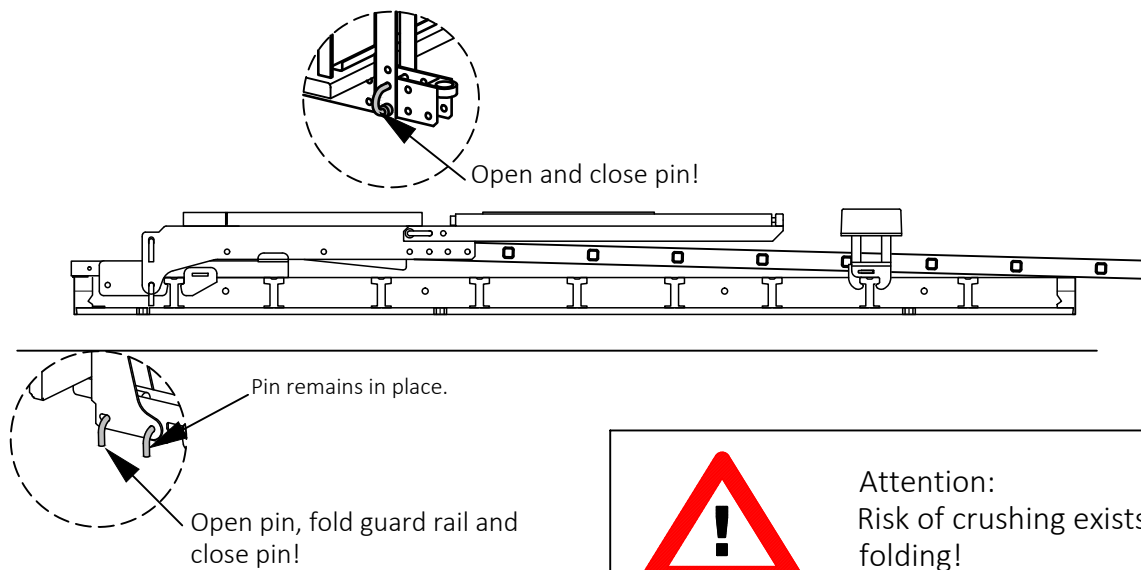

Attention:  
Risk of crushing exists when folding!

- Set the formwork down safely set down with the front side sitting level on squared timber or similar.
- Open both pins and fold up guard rails.
- Open pins and fold out platform; reclose pins.

- Attach diagonal strut and small strut of stabilizer with stabilizer connector to the top-hat profile of the panel and fasten by driving in the wedge.
- Readjust struts for length and reinsert pin of the large strut of stabilizer.

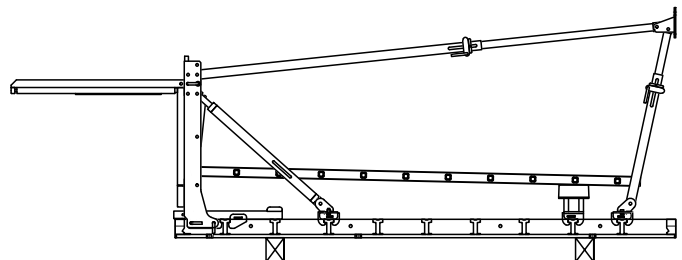

- Push ladder to the rear with the line of the ladder along the groove, engage, extend to length and attach ladder support.
- Swing out both side guard rails.
- If required, position front guard rails and secure with 2 locking pins.

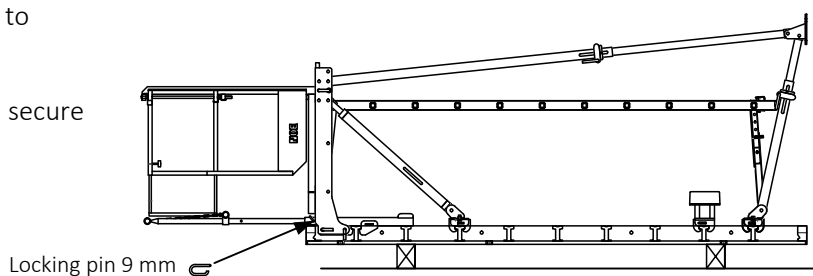

Fit lifting dog for erecting the formwork and attach crane rope to lifting dog.  
Lift slowly with the crane and move to the point of use.

- Open front plank and attach crane clamp.
- Fit lifting dog and attach crane rope.
- Carefully lift element using the crane, move to the point of use and set down.
- Anchor the stabilizers against tension and compression forces, and then remove crane rope.
- For information on how to proceed further, see → 4.2



For the mounting and use of the crane clamp and lifting dog observe the relevant operating instructions.



On each occasion before use, the scaffold is to be inspected, and all attachments checked that they sit correctly.

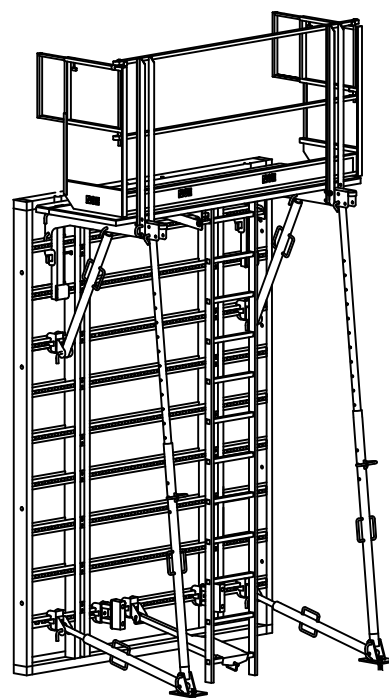

## 5 Details for use of NOEtop S formwork

### 5.1 Use of platform

#### 5.1.1 Folding the rear guard rail

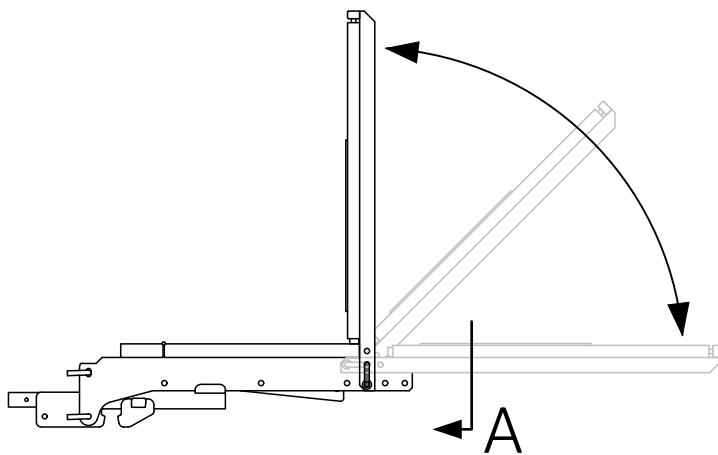

View A

◆ Open pin

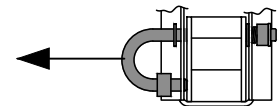

◆ Close pin

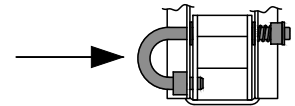

- ◆ Pull on the pin to open, and fold out guard rail. Then release pin so that it closes and re-engages.



#### 5.1.2 Folding up the platform

- ◆ Pull out pin the A (leave pin B in position!) and fold out platform by 90°. In this position reinsert pin A, and secure with spring pin.

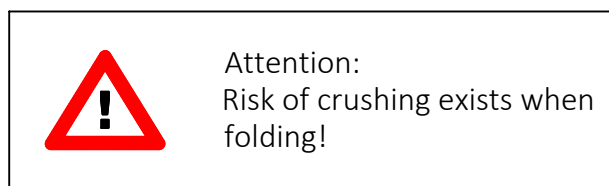
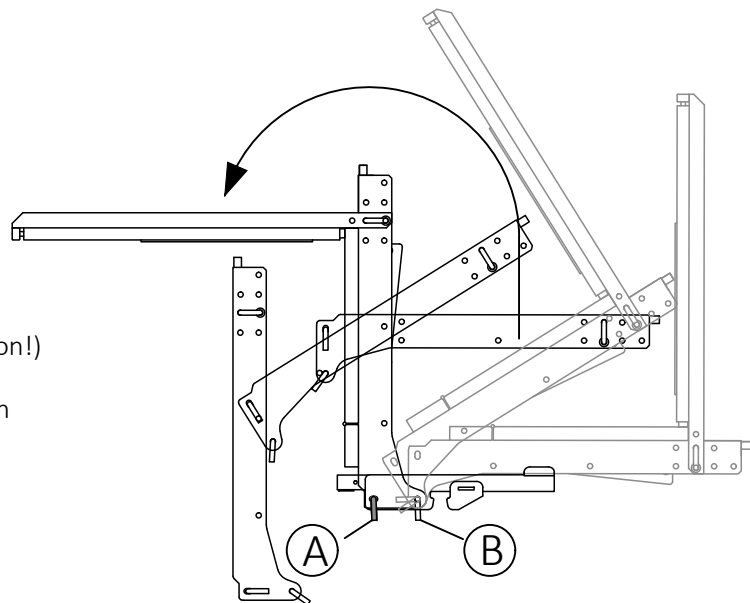

5.1.3 Attaching platform to the formwork

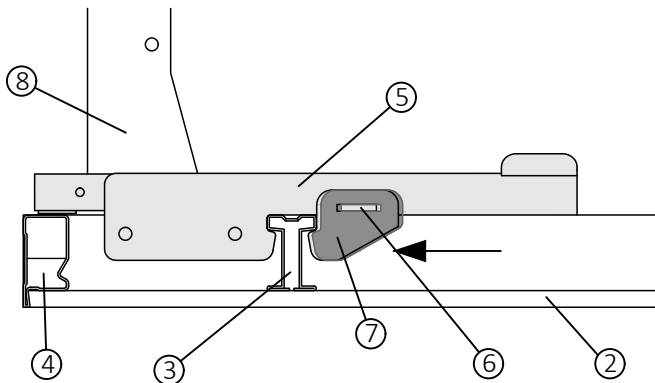

- ◆ Engage crane hook in the crane lugs, and move platform to the formwork.
- ◆ Suspend clamp with the lug in the uppermost top-hat profile section of the formwork panel, centralise platform, and drive in the wedge on both sides to close the wedge fixing.

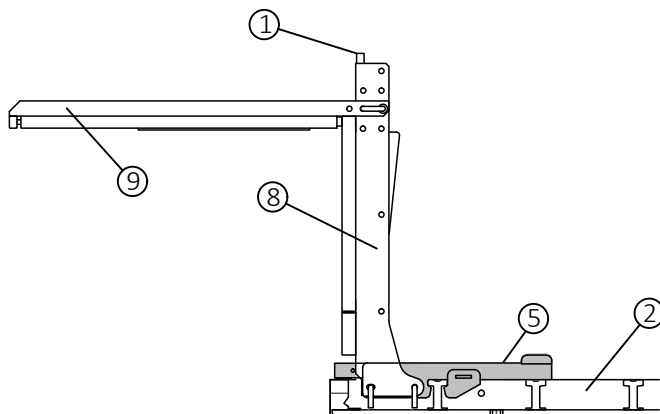

- 1 Crane lug
- 2 NOEtop formwork panel
- 3 Top-hat profile
- 4 Edge profile
- 5 Clamp
- 6 Wedge
- 7 Wedge fixing
- 8 Bracket of NOEtop S platform
- 9 Rear guard rail
- 10 Side guard rail
- 11 Extension
- 12 Screw with handle

5.1.4 Opening, closing and extending the side guard rails

- ◆ On delivery the side guard rails are folded down and anchored in the rear guard rails. To open, release the screw with handle so that it no longer engages in the rear guard rail and the side guard rail swings open by 90°.
- ◆ To extend the side guard rail release the screw further until the scaffold extension can be pulled out. Clamp and fix in the desired position by tightening the screw.

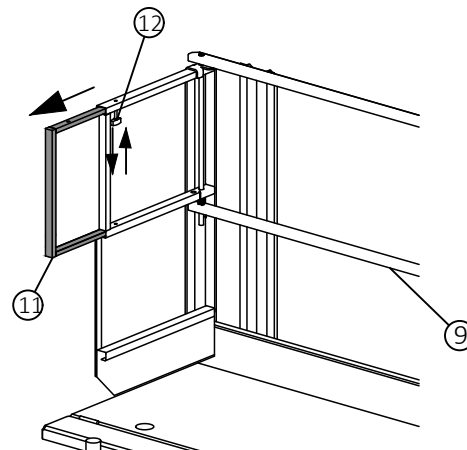
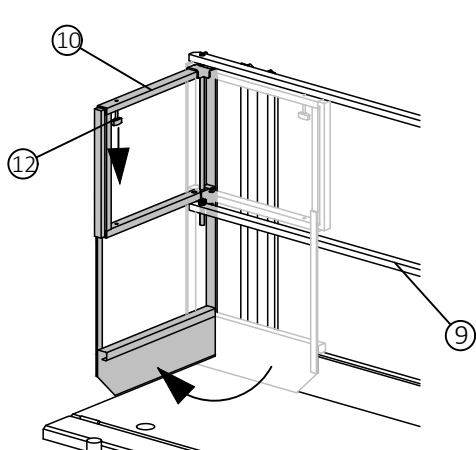

- ◆ To close the side guard rail release the screw, retract the extension, fold the side guard rail onto the rear guard rail, and re-tighten the screw to secure.

5.2 Attaching buffers to the formwork

- ◆ Use the clamping jaw to mount the buffers in the bottom top-hat profile, and secure by driving in the wedge.

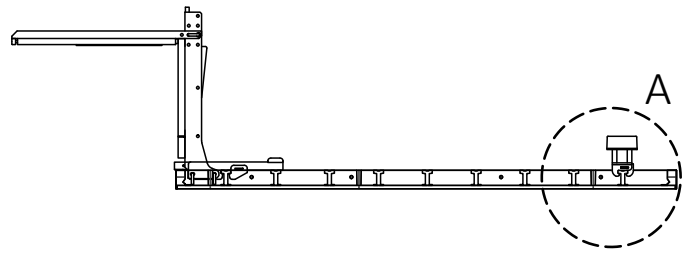

- 1 NOEtop frame formwork top-hat profile
- 2 buffer support
- 3 Clamp
- 4 Wedge

Detail A

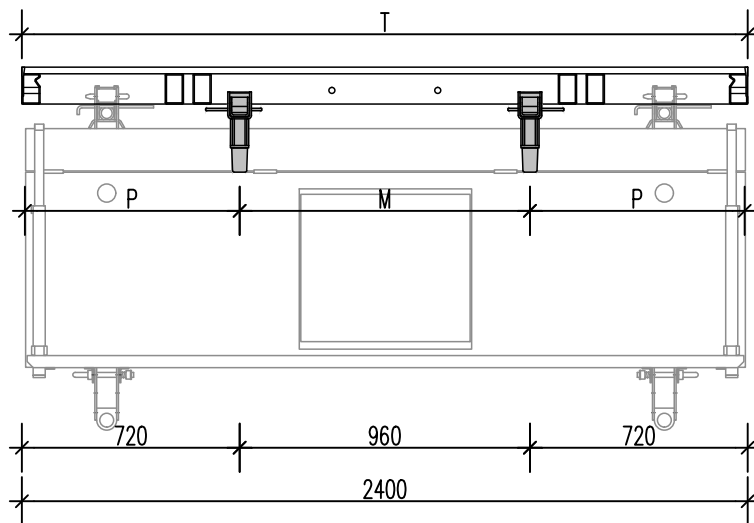
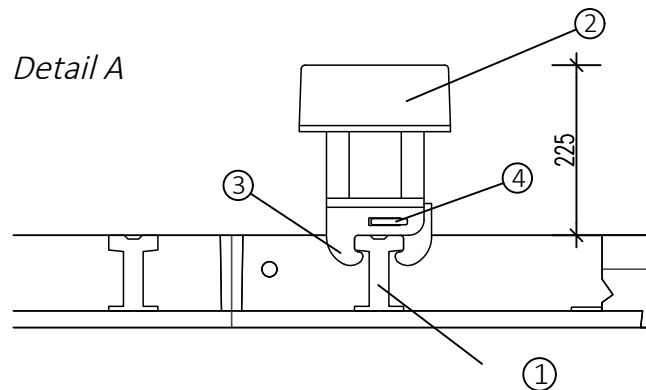

Panel width T [mm]	Buffer distance [mm]	
	P	M
2650	720	1210
1325	380	565
750	112	526
450	112	--

### 5.3 Attaching ladder and ladder connection

The ladders are attached to the platform with the aid of the ladder pivot. Depending on the formwork height, ladders can be combined and joined with ladder extensions.

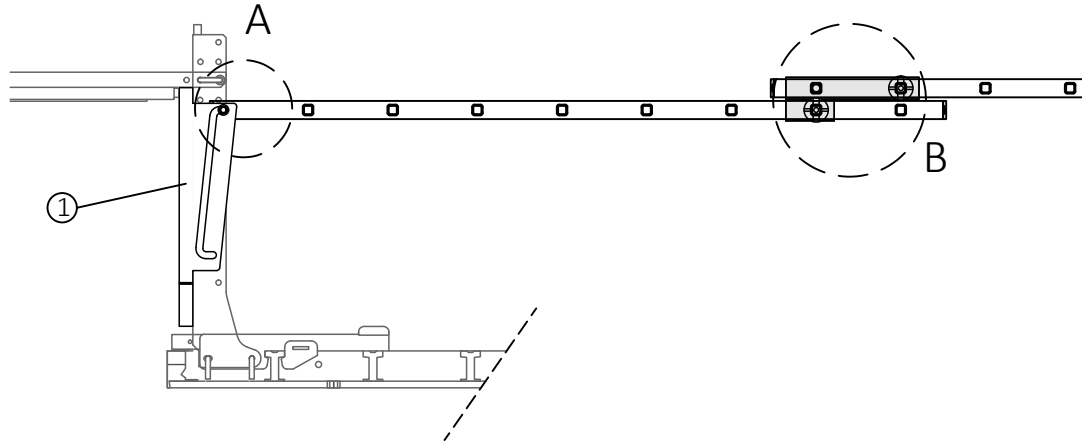

#### 5.3.1 Attaching the ladder

##### Detail A

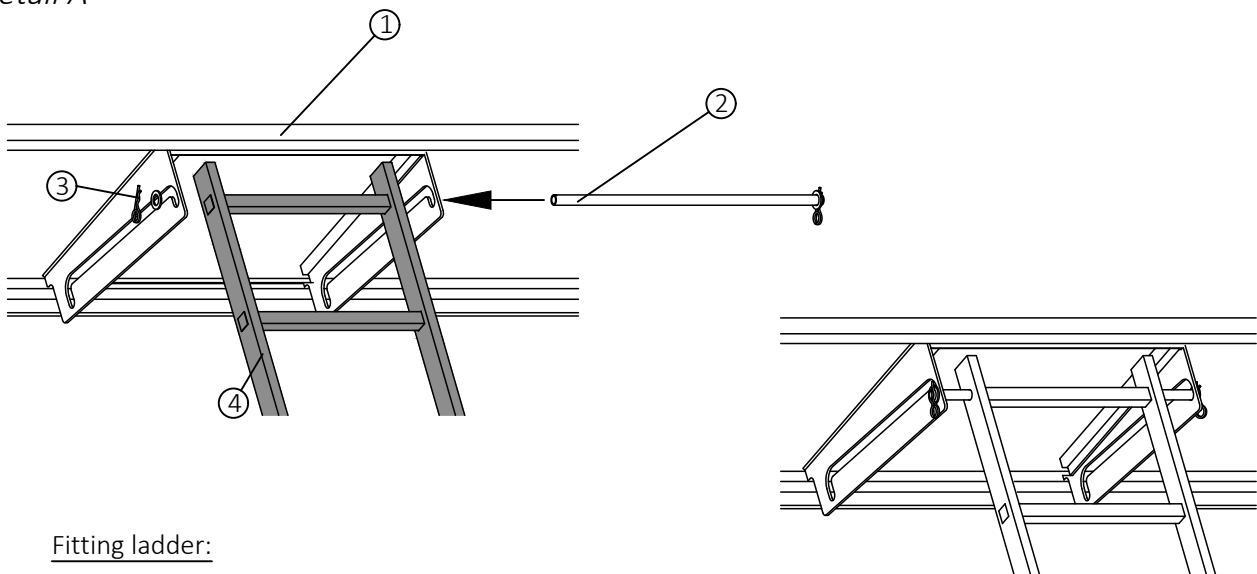

##### Fitting ladder:

- Remove the outer spring pin and washer on the ladder pivot of the NOEtop S platform and pull the pivot out of the side plates.
- Position and align the ladder, ensuring that the short projection of the ladder side rails is at the top.
- Push the ladder pivot through the side plates and the top rung opening of the ladder.
- Install washer and spring pin again to secure.

- 1 NOEtop S platform
- 2 Ladder pivot
- 3 Spring pin and washer
- 4 Ladder

### 5.3.2 Connecting 2 ladders

#### Detail B - Ladder connection butted or overlapped

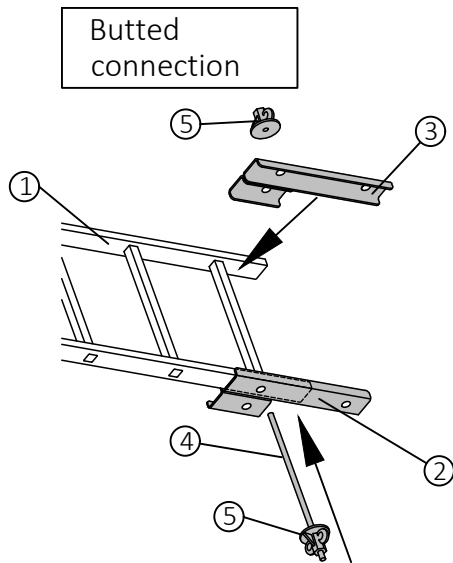

- 1 Ladder Part No. see 5.2
- 2 Ladder extender piece left  
TPart No. 126707
- 3 Ladder extender piece right  
Part No. 126708
- 4 Schwupp tie rod 60 cm  
Part No. 670600
- 5 Schwupp Sprint nut  
Part No. 680580

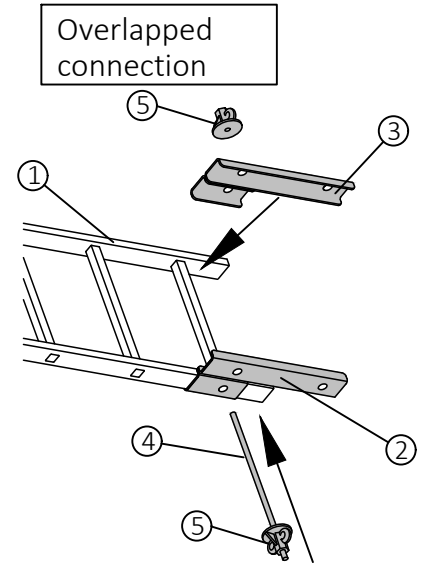

- ◆ Place the ladder extender pieces right and left on to the runner.  
Butted connection: fit long side piece  
Overlapped connection: fit short side piece

Screw the Sprint nut on to the tie rod, guide it through the ladder extender piece and the rung and fasten with second Sprint nut.

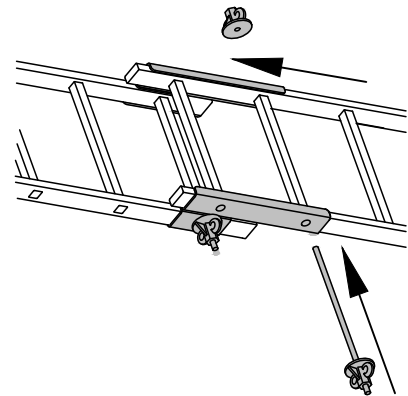
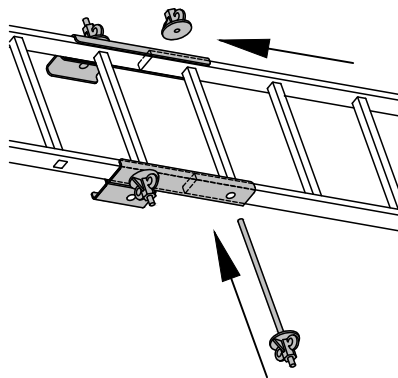

- ◆ Thread the ladder into the ladder extender piece, guide the tie rod through the hole and secure with the Sprint nuts.  
In the case of overlapped connections, the rung can be chosen to suit the required length.

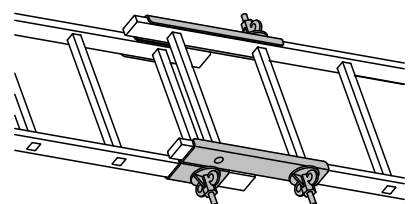
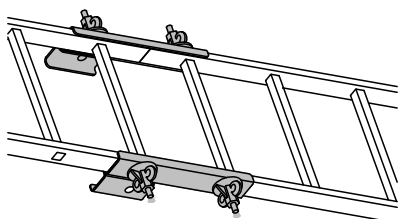



5.3.3 Attaching the ladder support

- ◆ Use the clamping jaw to mount the ladder support in the bottom top-hat profile, and secure by driving in the wedge.
- ◆ Fit tread plate with the edge on the rung and secure with spring pin. Adjust length of the ladder support as necessary.

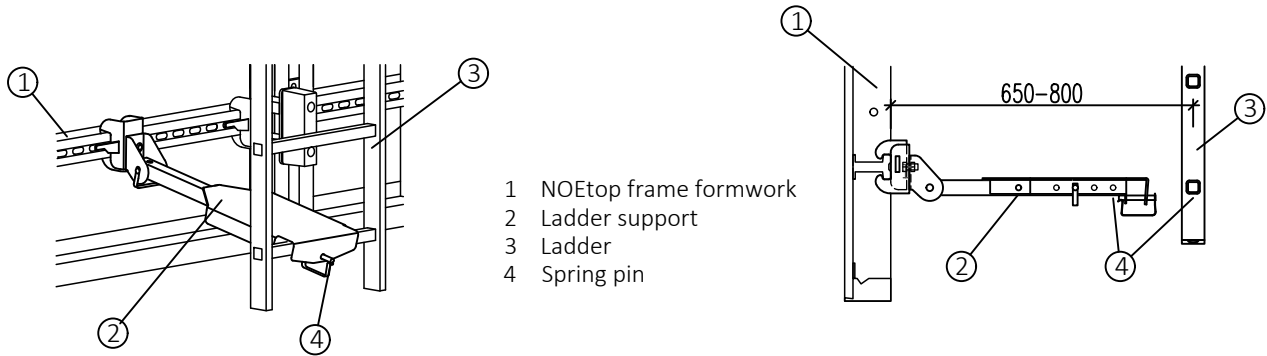

- ◆ In the case of extended platforms, instead of attaching the ladders to the formwork with the ladder support, they are attached to the rear guard rail with the ladder clamp fix to keep the walkways on the platform clear.

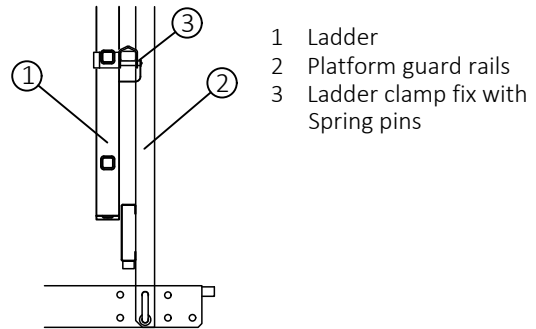

5.4 Stabilizers and struts

5.4.1 Attaching the stiffening struts

- ◆ Attach the stabilizer connector to the push-pull brace with an L-pin and secure with spring pin.
- ◆ Attach stabilizer connector in bracket axis on the top hat profile, and secure by driving in the wedge.
- ◆ Adjust push-pull brace for length and attach to bracket at top with L-pin and spring pin in middle or rear hole of bracket.

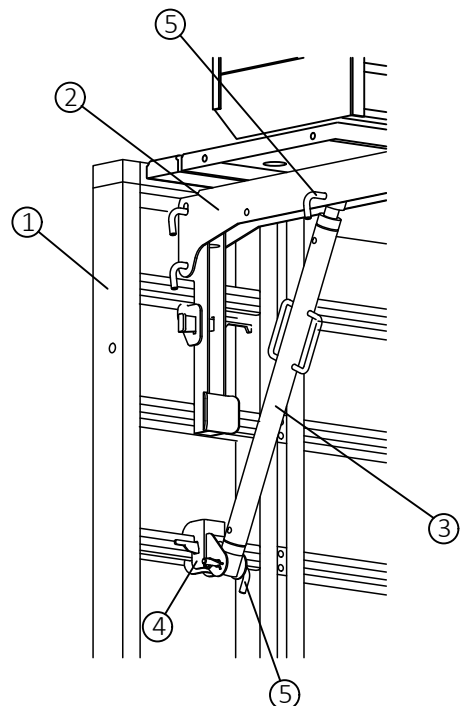
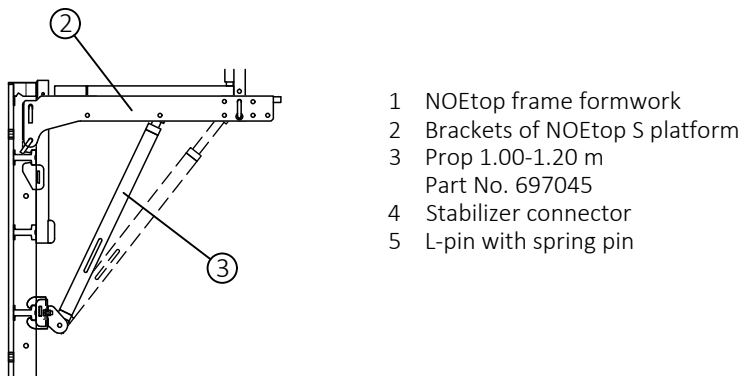

5.4.2 Attaching the stabilizers

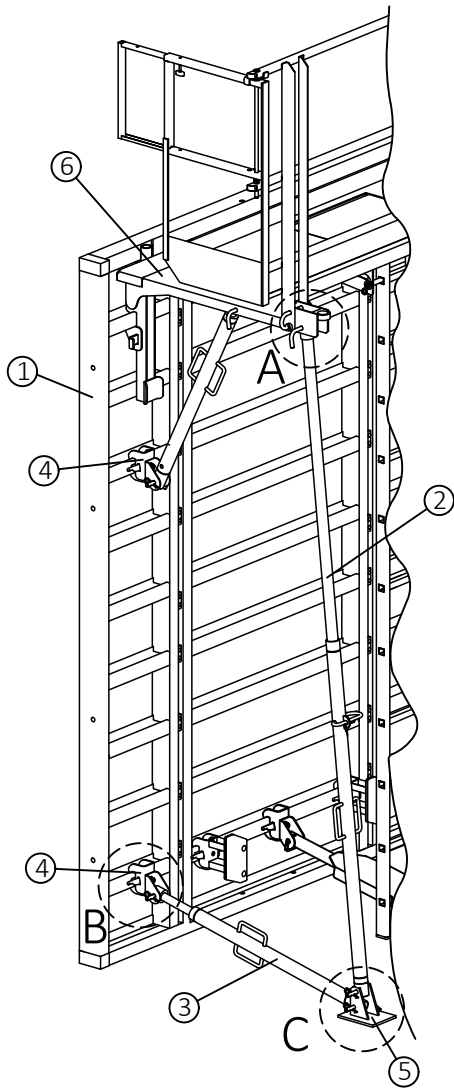

Detail A: Attachment to platform

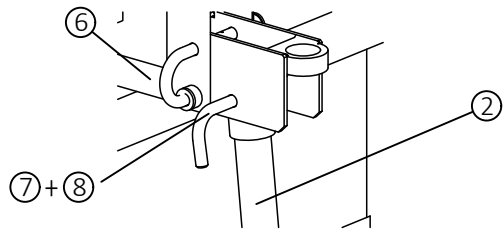

Detail B: Attachment to formwork

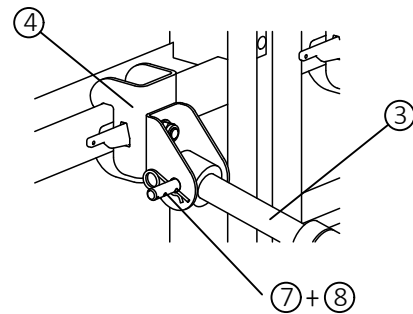

Detail C: Attachment to base support plate

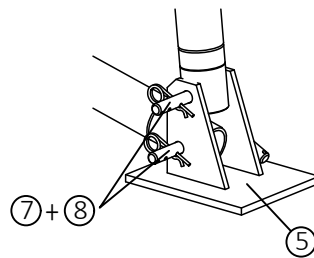

- 1 NOEtop frame formwork
- 2 Stabilizer long strut
- 3 Stabilizer short strut
- 4 Stabilizer connector Part No. 697032
- 5 Base support plate Part No. 697014
- 6 Scaffold platform NOEtop S
- 7 L-pin Ø16 Part No. 697010
- 8 Spring pin Ø4 mm Part No. 913304

5.5 Outside corner solution for 90° corners

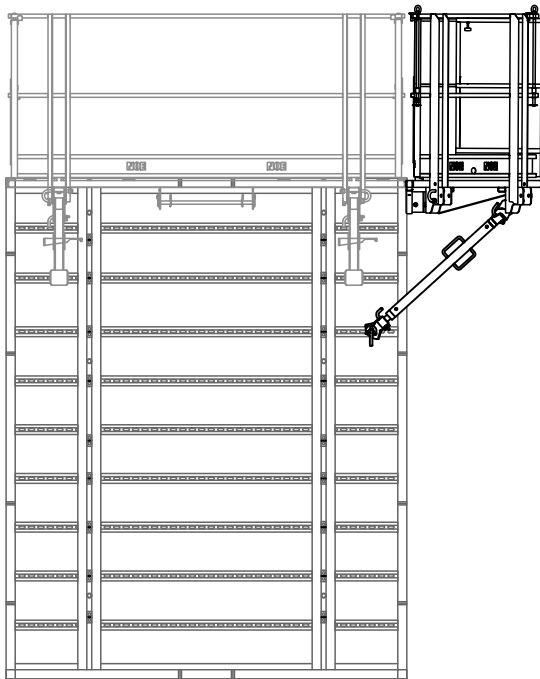

Attach end platform to NOEtop S

- ◆ Lift end platform using a crane and position it at the NOEtop S platform.
- ◆ Bolt the platforms together.
- ◆ Attach the support strut to the end platform and formwork.

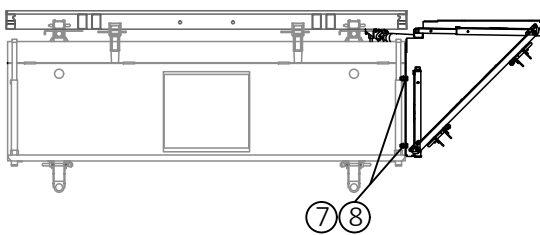

Side guard rail  
(hinged and extendable)

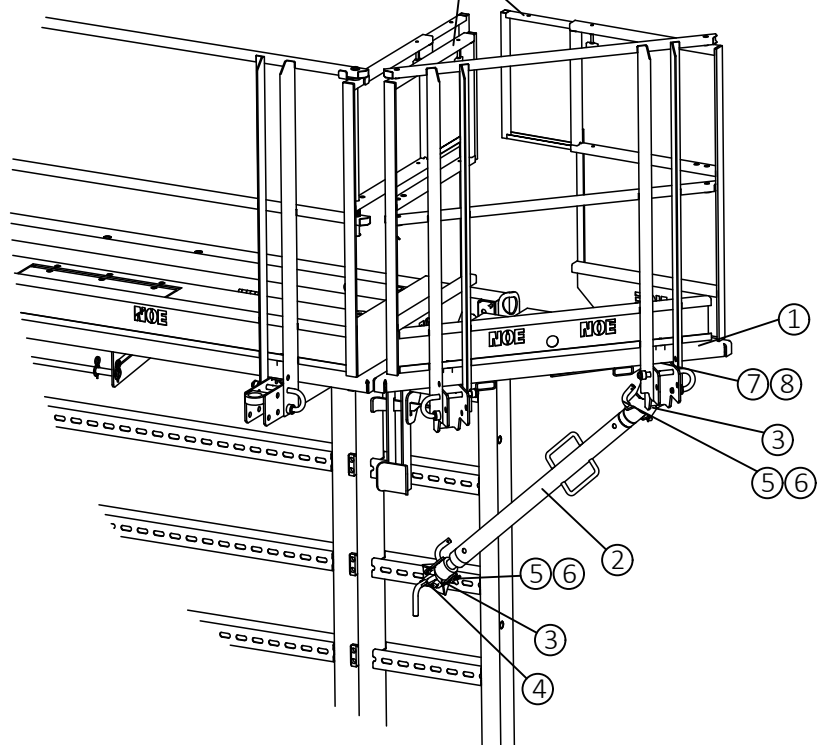

- 1 NOE end platform  
Part No. 408338 (1 No.)
- 2 Brace 1.00 - 1.20 m  
Part No. 697045 (1 No.)
- 3 Hinge  
Part No. 697012 (2 No.)
- 4 Hammer-head bolt  
Part No. 319338 (1 No.)
- 5 L-pin D16  
Part No. 697010 (2 No.)
- 6 Spring pin  
Part No. 913304 (2 No.)
- 7 Safety nut (3 No.)
- 8 M16x40 (3 No.)

## 6 Standard application of NOEtop S scaffold

- ◆ In the case of extended formwork the scaffold can be attached to horizontal top hat profiles. Select stabilizers to ensure structural stability and choose ladders so that a safe ascent is possible.

If necessary, intermediate levels can be added, taking account of the relevant safety regulations, if the access ladders are in an offset arrangement.

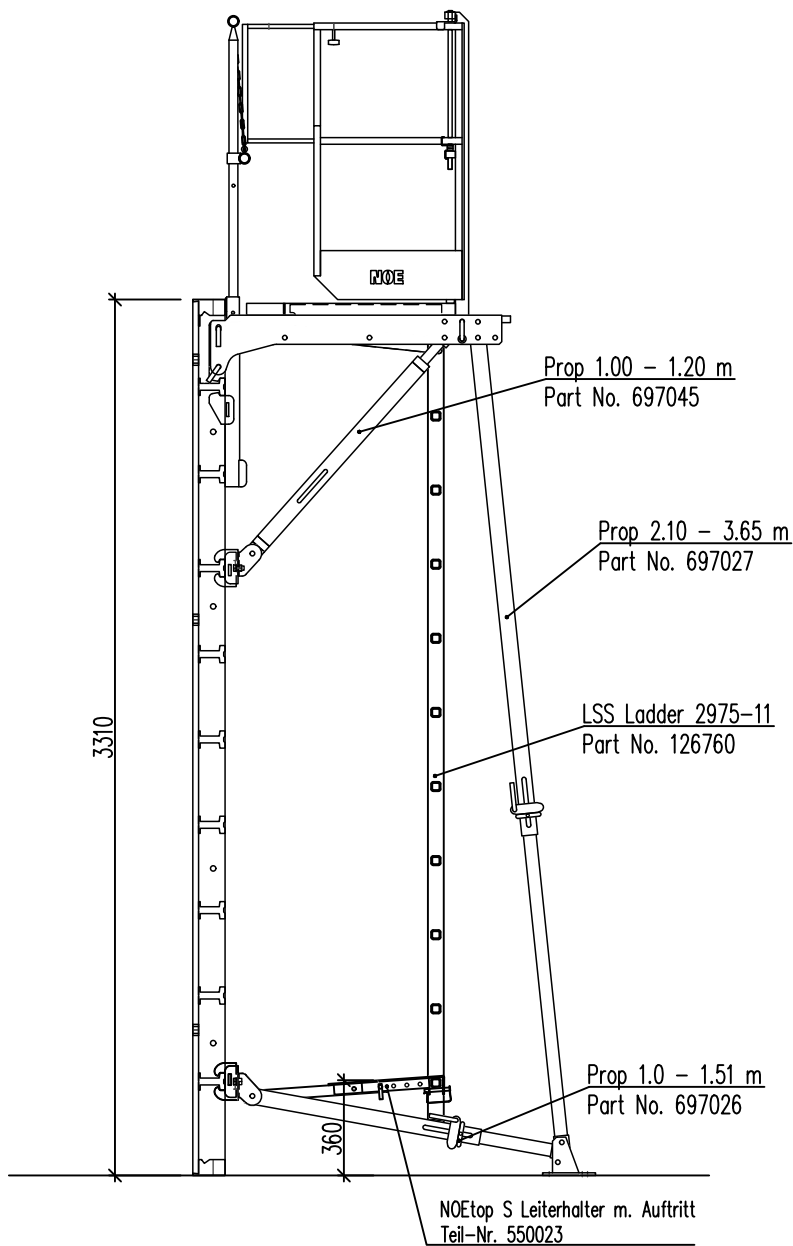

Standard section 2650 mm

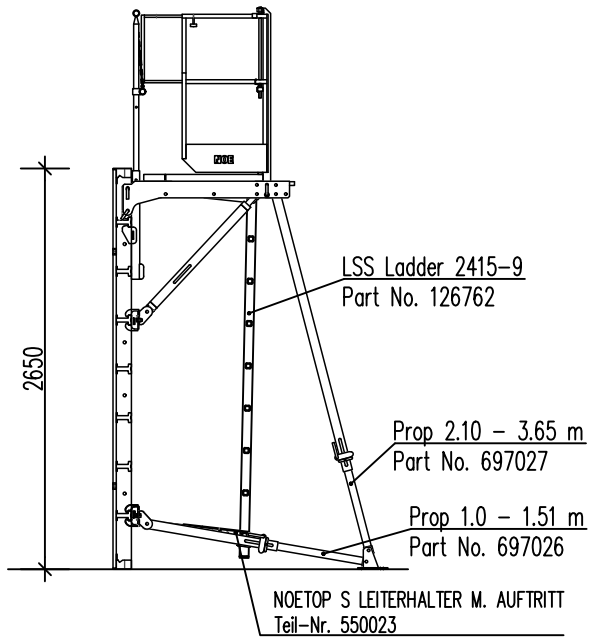

Standard section 3310 + 3310 mm

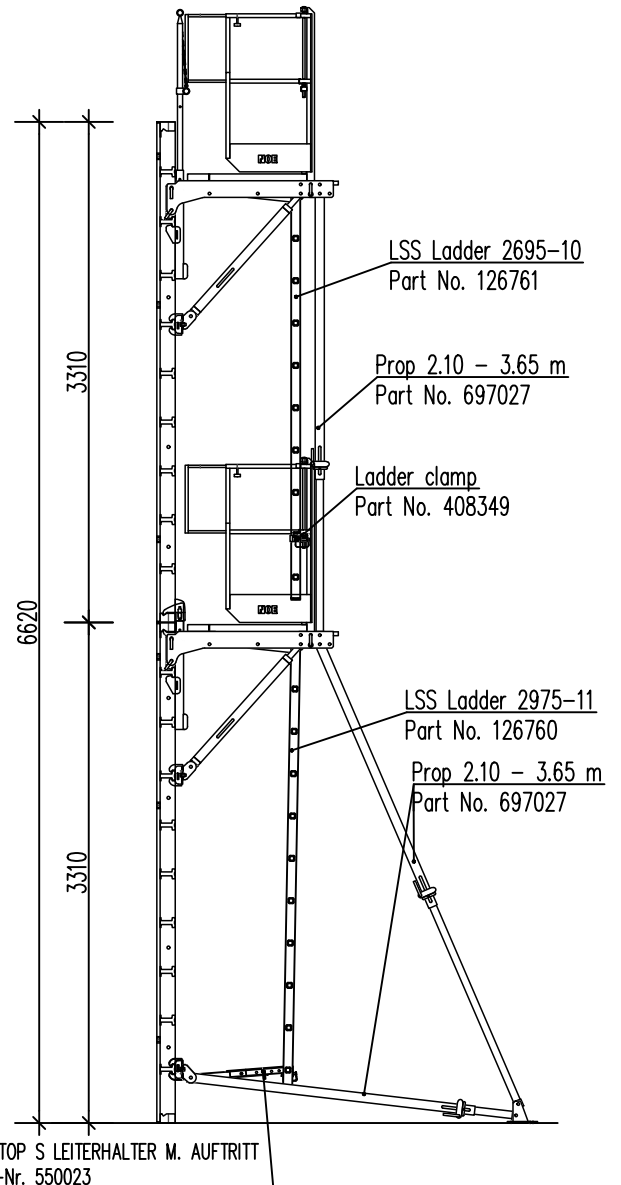

Standard section 2650 + 2650 mm

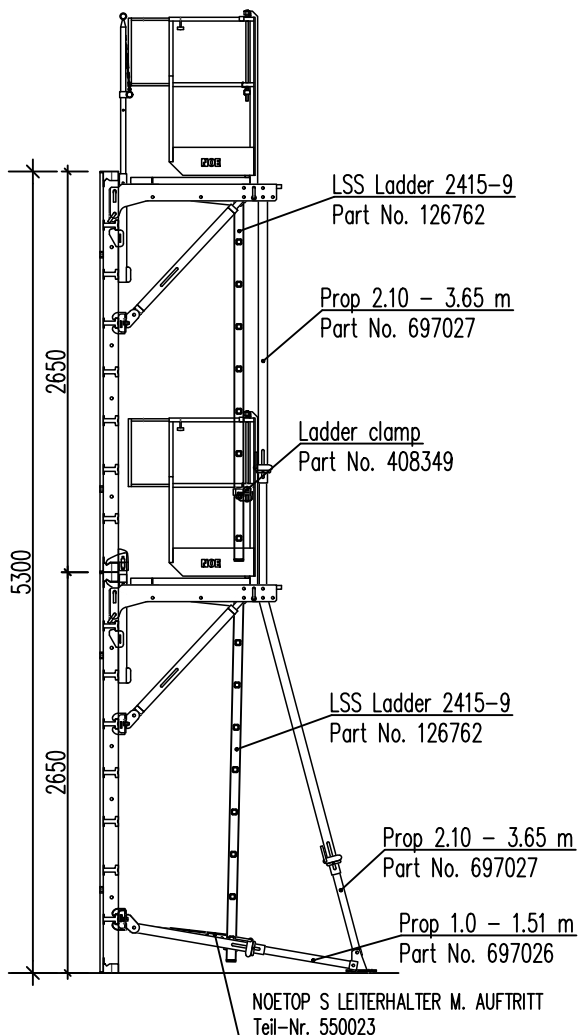

### 7 Corner solutions and compensation areas

◆ For corner solutions, stop-end formwork and compensation areas, specially adapted platforms must be used.

If necessary, please contact your NOE contact person.

### 8. Stacking and moving by crane

Folded assembled elements can be stacked for transport. Buffer supports and buffers fitted in the platform boarding can serve as supports for elements. Up to a maximum of 5 stacked elements can be transported.

#### Elevation

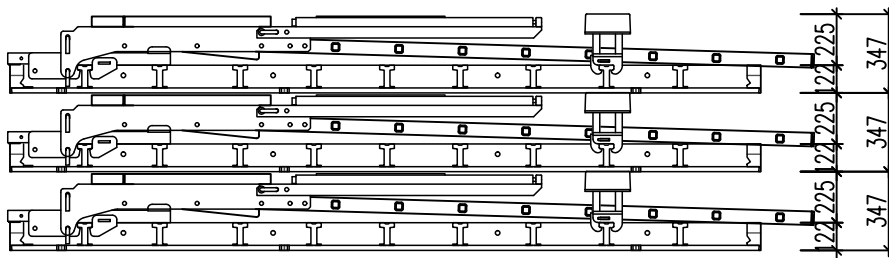

#### Plan view (shown without ladders and stabilizers)

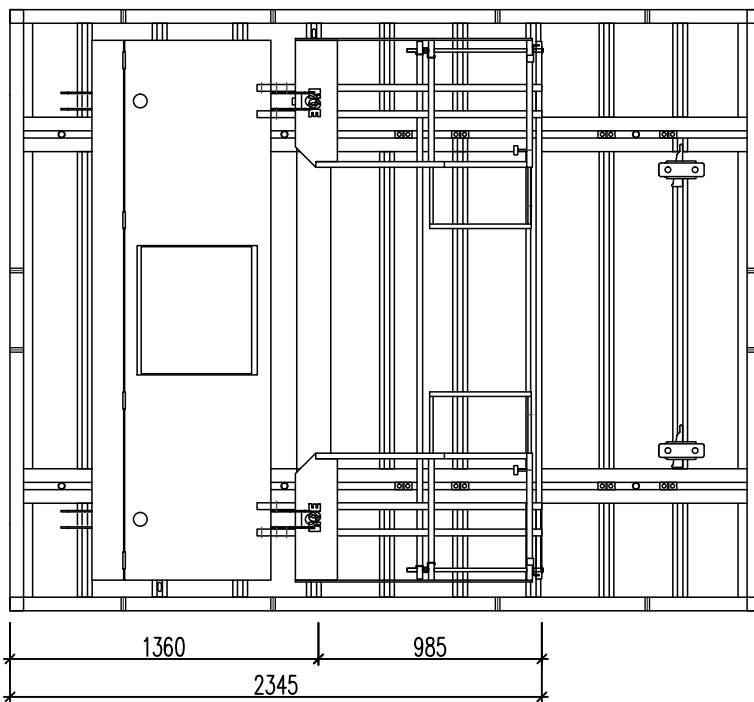

Units can be transported horizontally with lifting pins in the transverse holes of the panels, and vertically using NOEtop crane clamps. More information on this can be found in the instructions and operating manual for the NOEtop formwork.

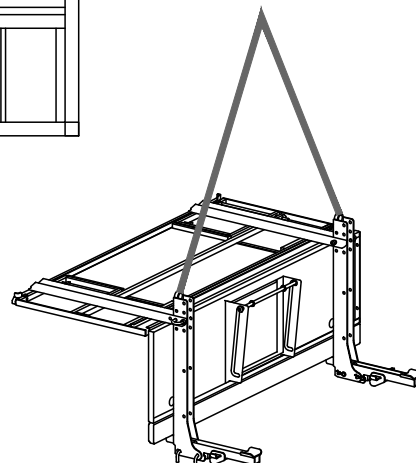

Individual platforms are moved by attaching crane hooks to the crane lugs.

### 9. Individual parts

#### NOETop panels for scaffold attachment

Description	Height [mm]	Width [mm]	Part No.	Weight [kg]
NOETOP S PANEL MFP 2650X660 MM NOETOP PANEL 1325 X 660 GALV. NOETOP PANEL 750 X 660 GALV. NOETOP PANEL 450 X 660 GALV.	660	2650 1325 750 450	169912 163019 163309 163749	139 64 42 31
NOETOP PANEL MFP 1325 X 2650 NOETOP PANEL 1325 X 1325 GALV. NOETOP PANEL 750 X 1325 GALV. NOETOP PANEL 450 X 1325 GALV.	1325	2650 1325 750 450	168020 169009 169309 169749	260 112 74 55
NOETOP PANEL LS 2650 N+F NOETOP PANEL 1325 X 2650 GALV. NOETOP PANEL 750 X 2650 GALV. NOETOP PANEL 450 X 2650 GALV.	2650	2650 1325 750 450	168053 168019 168309 168749	479 205 136 100
NOETOP PANEL LS 3310 N+F NOETOP PANEL 1325 X 3310 GALV. NOETOP PANEL 750 X 3310 GALV. NOETOP PANEL 450 X 3310 GALV.	3310	2650 1325 750 450	168052 160065 160068 160073	590 253 168 124

#### NOETop S scaffolds

Scaffold platform

incl.

- Brackets
- Platform
- Rear guard rails
- Side guard rails
- Attachment

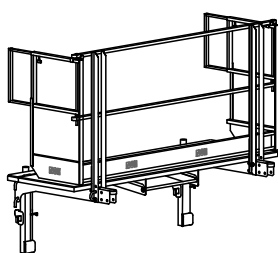

Width [mm]	Number of Brackets	Hatch	Side guard rail r/l	Part No.	Weight [kg]
2650	2	x	x	550061	192,8
1325	2	x	x	550063	142,7
750	2			550066	93,3
450	1			550070	48,0

Attachment is done by clamps and wedges, no additional parts being needed.

#### Stiffening strut

Part No. 697045

Weight 8.4 kg

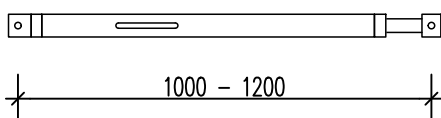

*NOEtop S front guard rail*

*If necessary attach as fall protection.*

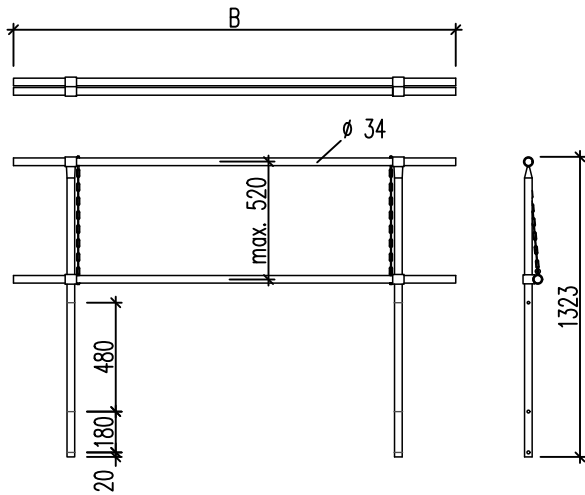

System width [mm]	Width B [mm]	Part No.	Weight [kg]
2650	2600	550131	21,9
1325	1275	550133	14,9
750	700	550136	11,8
450	400	550140	6,3

Secure front guard rail with 2 locking pins 9 mm.

*Locking pin 9 mm*

Part No. 890834



*NOEtop S buffer support*

*Attach to formwork for stacking elements*

Part No. 550142

Weight 5.37 kg

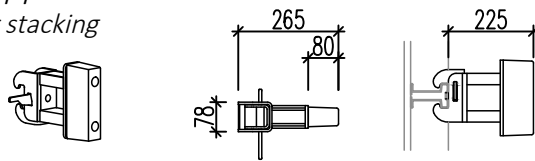

*NOEtop S ladder connection*

*For attaching older ladders with longer side rail projections to the ladder pivot*

Part No. 126758

Weight 0.8 kg

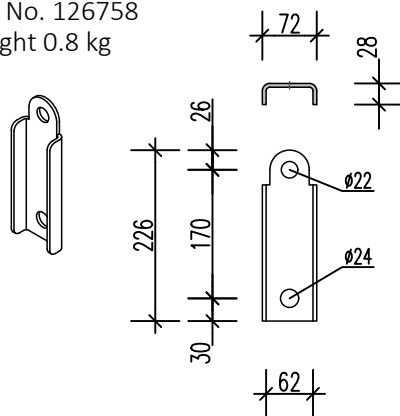

*NOEtop S ladder support*

Part No. 550023

Weight 9.4 kg

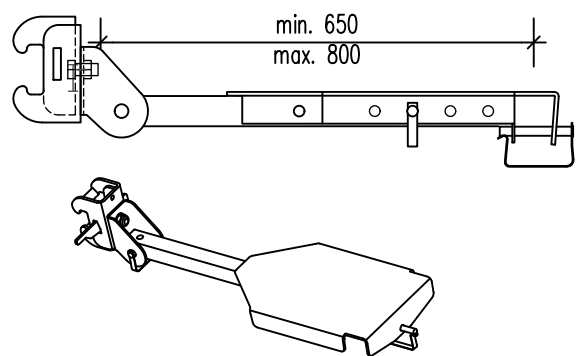

*Each ladder attachment requires:*

St.	Part No.	Description
2	126758	Ladder connection
1	670600	Tie rod 60 cm
2	680580	Sprint nut

*Ladder clamp fix*

Part No. 408349

Weight 0.5 kg

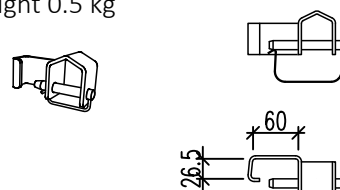



NOE LSS ladders

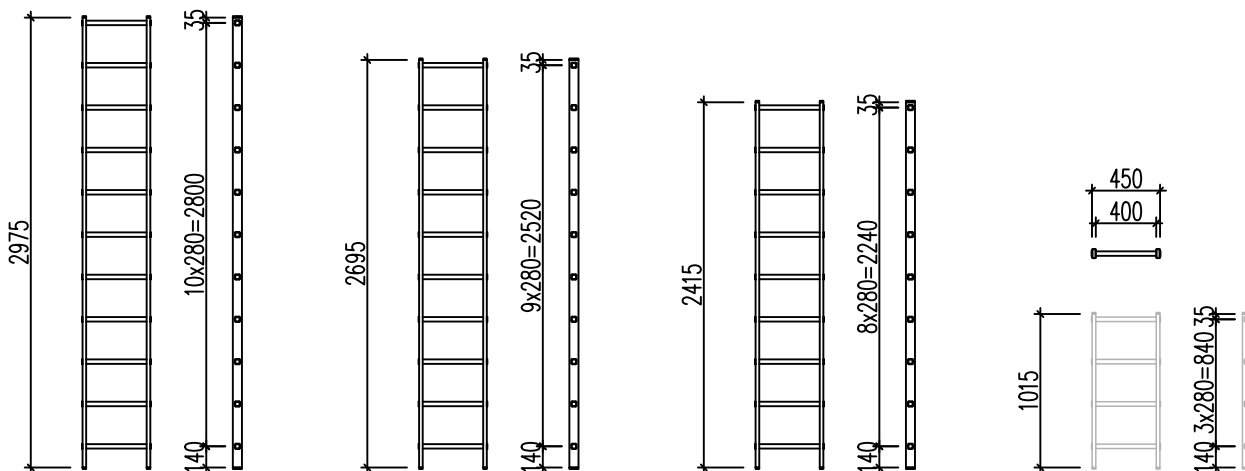

NOE LSS ladder	Length [mm]	Rungs	Part No.	Weight [kg]
	2975	11	126760	7,8
	2695	10	126761	7,0
	2415	9	126762	6,3
1015	4	126764	2,7	

lengths without caps

Ladder extender piece left

Part No. 126707  
Weight 2.6 kg

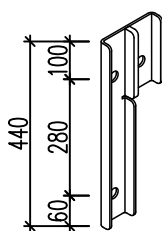

Ladder extender pieces right

Part No. 126708  
Weight 2.6 kg

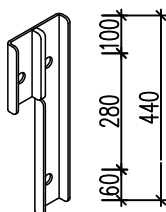

Tie rod  $\varnothing 15$  L=60 cm

Part No. 670600  
Weight 0.82 kg

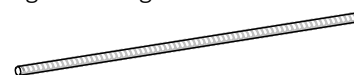

Sprint nut

Part No. 680580  
Weight 0.69 kg



Each ladder connection requires the following items:

St.	Part No.	Description
1	126707	Ladder extender piece left
1	126708	Ladder extender pieces right
2	670600	Tie rod $\varnothing 15$ L=60 cm
4	680580	Sprint nut

*Stabilizers*

*Stabilizers for formwork heights up to 3310 mm*

- 1 Push/pull brace 1750-3100 mm  
Part No. 697044 (1 pc.)  
alternatively  
Part No. 697027 (2100-3650 mm)
- 2 Push/pull brace 1000-1200 mm  
Part No. 697045 (1 pc.)  
alternatively  
Part No. 697026 (1000-1510 mm)
- 3 Base plate  
Part No. 697014 (1 pc.)
- 4 L-pin D16  
Part No. 697010 (4 pcs.)
- 5 Spring pin  
Part No. 913304 (4 pcs.)
- 6 Stabilizer connector  
Part No. 697032 (1 pc.)

*Plan bottom support*

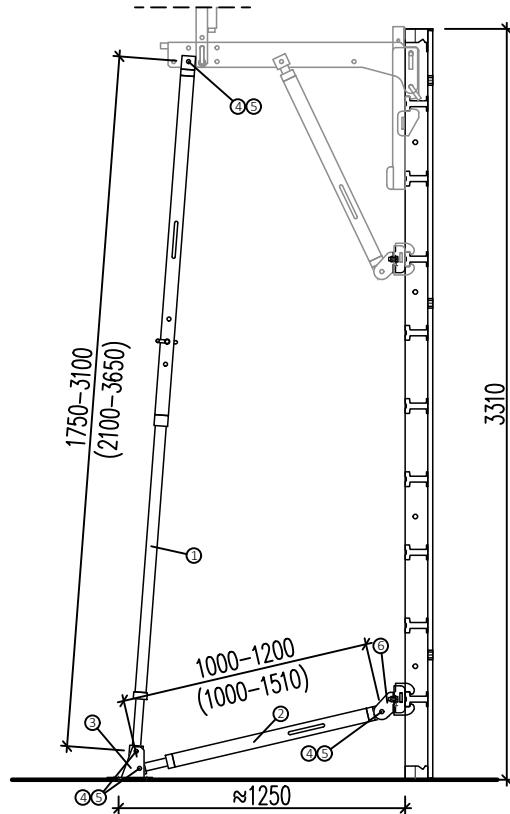
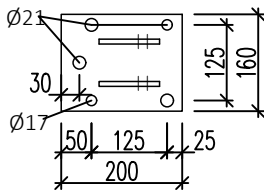

*Stabilizers for formwork heights 2650-3975 mm*

- 1 Push/pull brace 2100-3650 mm  
Part No. 697027 (1 pc.)\*
- 2 Push/pull brace 1000-1510 mm  
Part No. 697026 (1 pc.)
- 3 Base plate  
Part No. 697014 (1 pc.)
- 4 L-pin D16  
Part No. 697010 (4 pcs.)
- 5 Spring pin  
Part No. 913304 (4 pcs.)
- 6 Stabilizer connector  
Part No. 697032 (1 pc.)

\* For formwork heights greater than 3900 mm the platform must be attached in the second top-hat profile from the top. Above formwork height of 3310 mm can alternatively use the prop Part No. 697028 (2770-5000 mm).

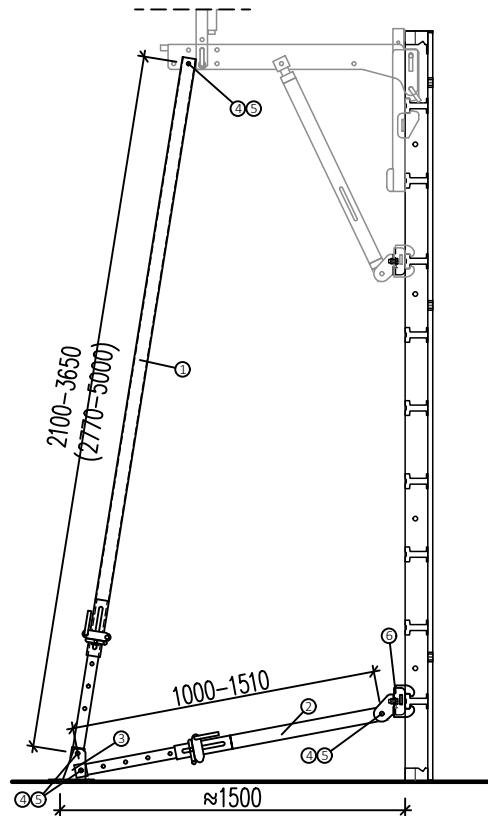

For stabilizers on formwork elements without scaffold units, see instructions and operating manual for NOEtop.



**THE FORMWORK**



**NOE-Schaltechnik  
Georg Meyer-Keller GmbH + Co. KG**

Kuntzestrasse 72, 73079 Süssen, Germany  
T + 49 7162 13-1  
F + 49 7162 13-288  
info@noe.de  
www.noe.eu

**Belgium**

NOE-Bekistingtechniek N.V.  
info@noe.be  
www.noe.eu

**France**

NOE-France  
info@noefrance.fr  
www.noe.eu

**Netherlands**

NOE-Bekistingtechniek b.v.  
info@noe.nl  
www.noe.eu

**Austria**

NOE-Schaltechnik  
noe@noe-schaltechnik.at  
www.noe.eu

**Poland**

NOE-PL Sp. Zo.o.  
noe@noe.pl  
www.noe.pl

**Switzerland**

NOE-Schaltechnik  
info@noe.ch  
www.noe.eu